



Foel Fach Wind Farm Limited.

# Foel Fach Wind Farm – Environmental Statement Volume IV

Chapter 2 Description of the Proposed Development Figures

Project Reference: 664094

DECEMBER 2025



Energy for  
generations





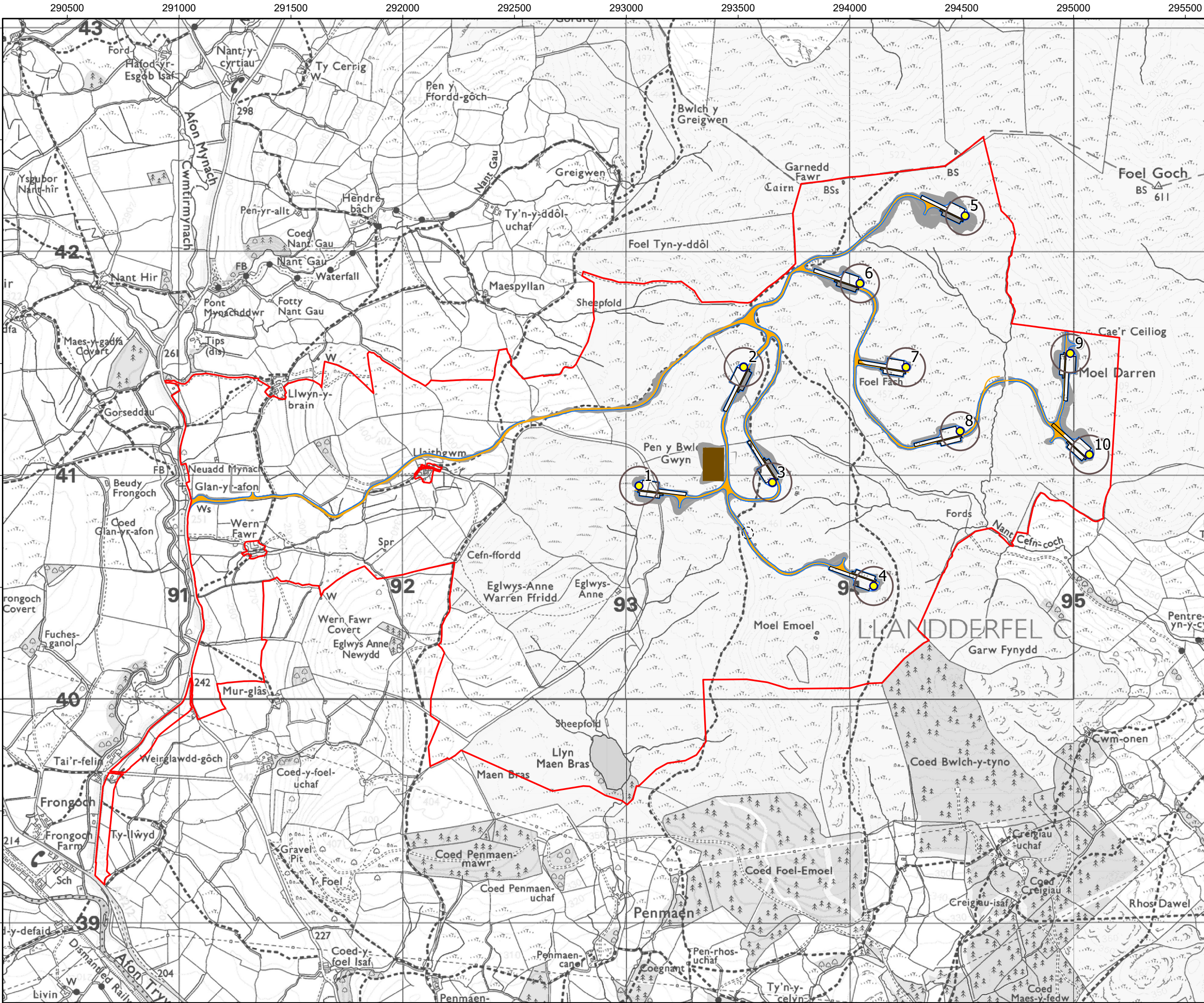

- LEGEND:**
- Turbine
  - Turbine Oversail
  - Site Boundary
  - LIDAR Compound
  - Hardstands
  - Tracks
  - Verges
  - Substation / BESS
  - Cut and Infill Extent

Coordinate System: British National Grid  
Projection: Transverse Mercator  
Datum: OSGB 1936  
Units: Meter  
Client: ESB/Coriolis Energy



Rev	Date	Description	Drn	Chk	App
00	03/11/2025	First Issue	AW	KS	KS

Foel Fach Wind Farm



TITLE: Figure 2.1 Development Layout

ID: P664094\_Figure2-1\_DevelopmentLayout

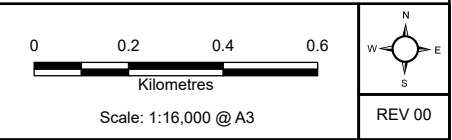



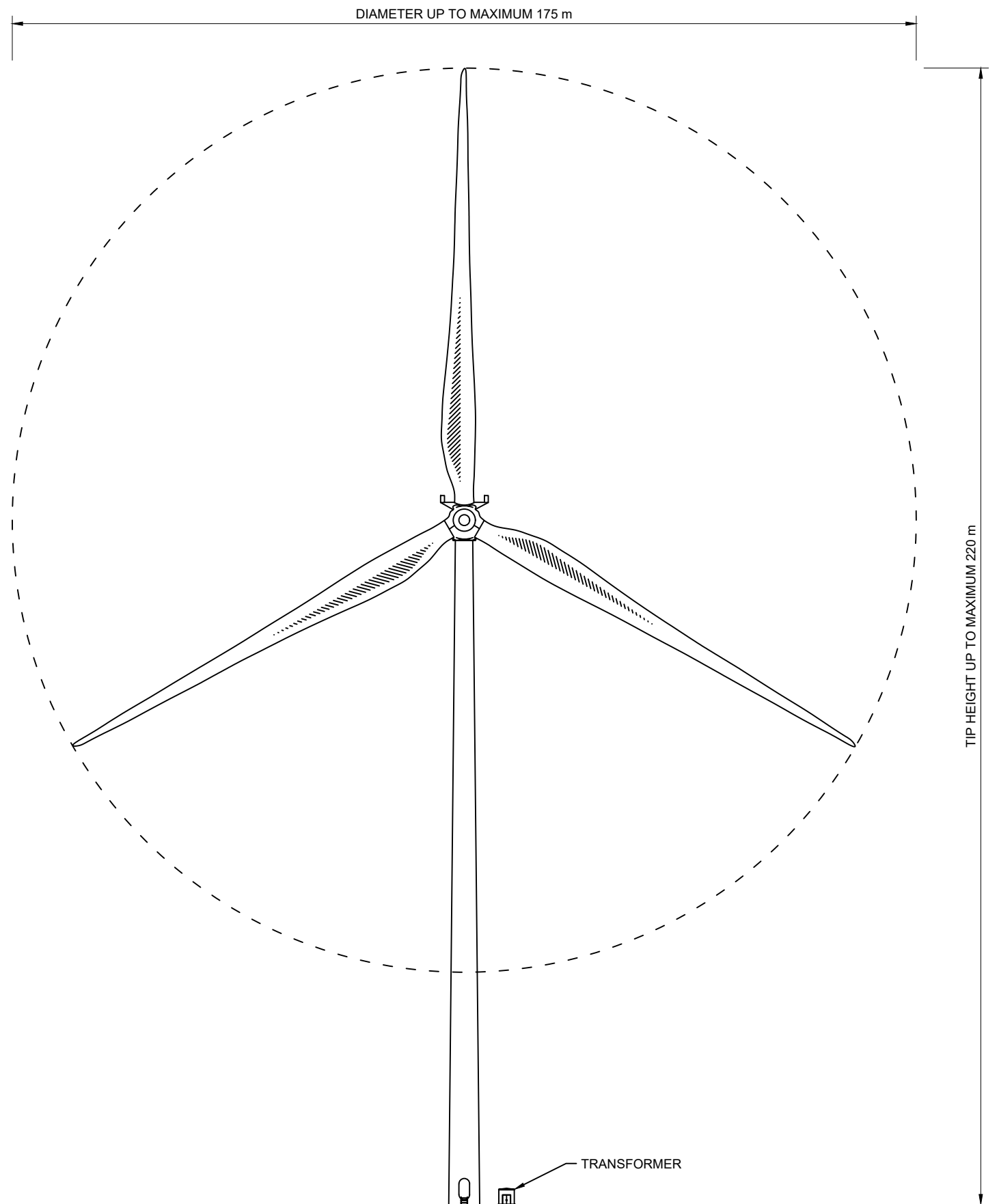

FRONT ELEVATION VIEW

SCALE 1:1000

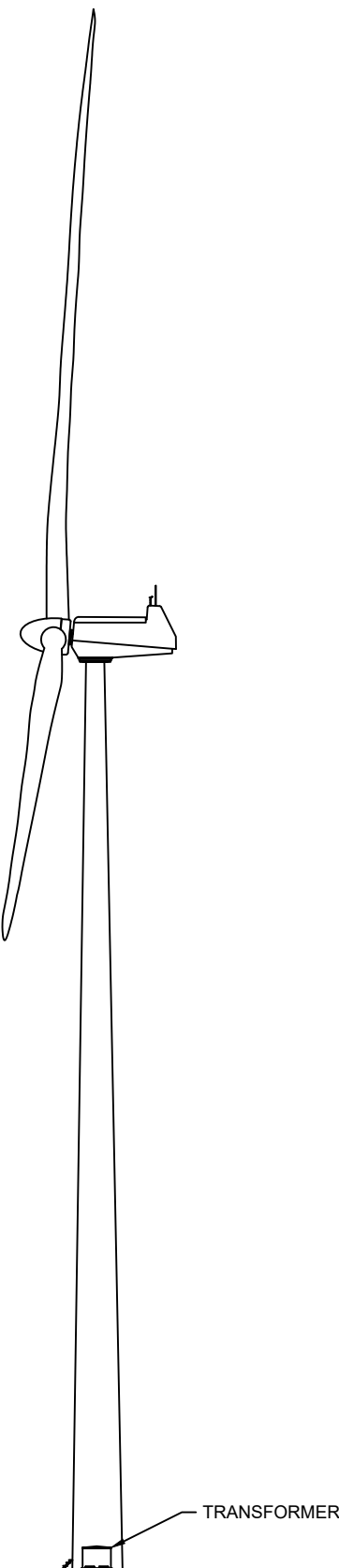

SIDE ELEVATION VIEW

SCALE 1:1000



**LEGAL:** NATURAL POWER CONSULTANTS LTD TAKES NO RESPONSIBILITY FOR THE ACCURACY OF DATA PROVIDED BY THIRD PARTIES.

**NOTES:**

1. THIS IS A INDICATIVE ARRANGEMENT ONLY AND NOT FOR CONSTRUCTION.

D	DIMENSIONS & TITLE UPDATED	AL	MB	JS	31/10/25
C	TITLE UPDATED	AL	MB	JS	28/08/25
B	TITLE UPDATED	AL	MB	JS	25/06/25
A	INITIAL ISSUE	AL	MB	JS	13/05/25
REV	DESCRIPTION	BY	CH	APP	DATE

FOEL FACH WIND FARM

TITLE: FIGURE 2.2  
INDICATIVE WIND TURBINE ELEVATION

306.30605	1387709
-----------	---------

FOR INFORMATION

SCALE: 1:1000  
18599\_DET\_3003

D

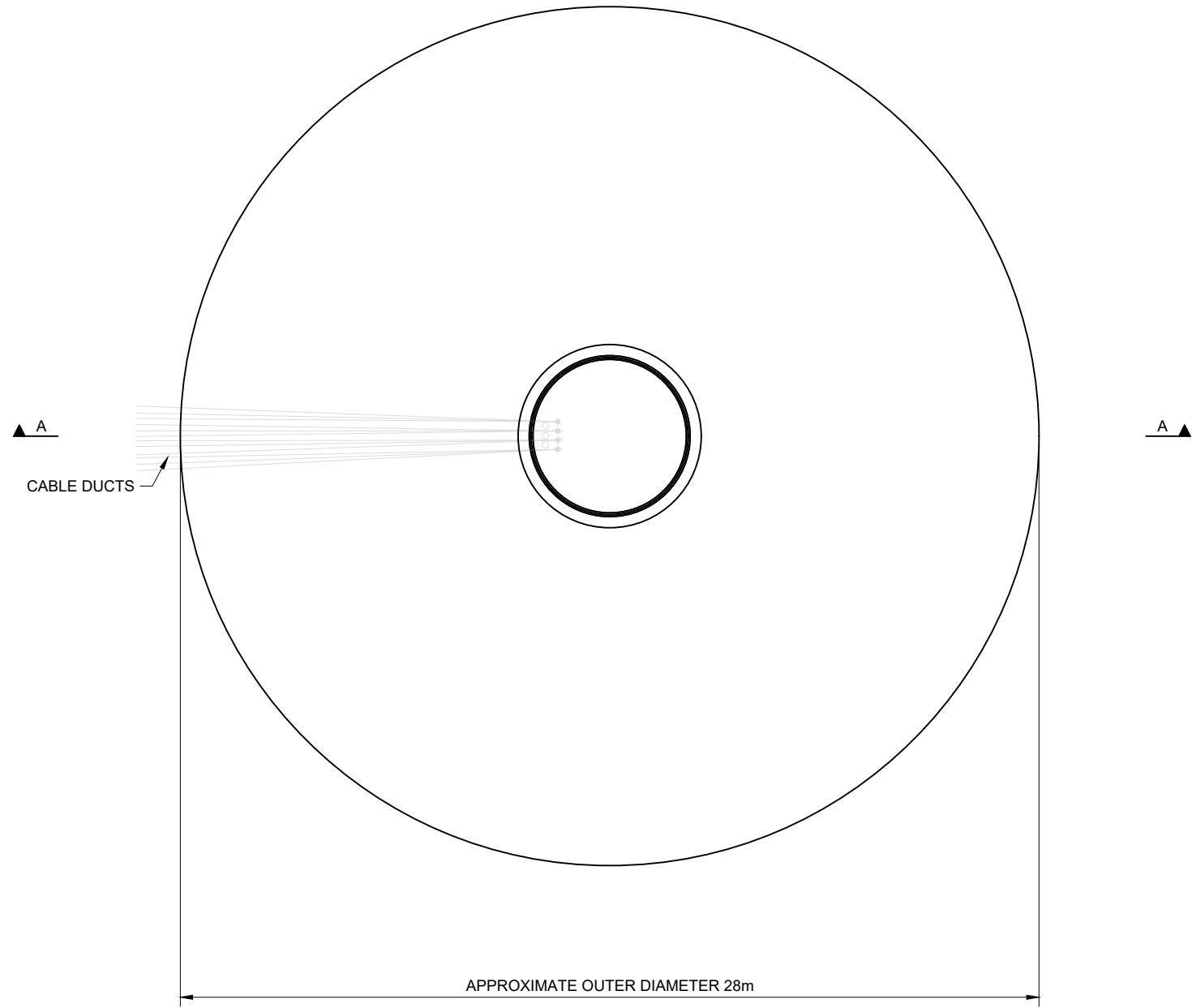

**PLAN VIEW**  
SCALE 1:200

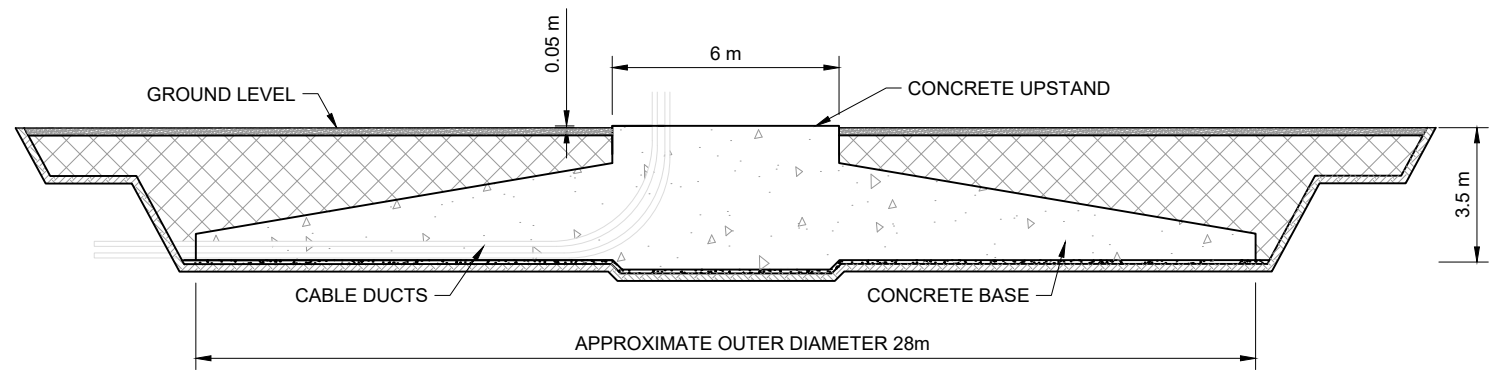

**SECTION A-A**  
SCALE 1:200



**LEGAL:** NATURAL POWER CONSULTANTS LTD TAKES NO RESPONSIBILITY FOR THE ACCURACY OF DATA PROVIDED BY THIRD PARTIES.

**NOTES:**

- THIS IS A INDICATIVE ARRANGEMENT ONLY AND NOT FOR CONSTRUCTION.

D	NOTE & TITLE UPDATED	AL	MB	JS	31/10/25
C	TITLE UPDATED	AL	MB	JS	28/08/25
B	TITLE UPDATED	AL	MB	JS	25/06/25
A	INITIAL ISSUE	AL	MB	JS	13/05/25
REV	DESCRIPTION	BY	CH	APP	DATE

FOEL FACH WIND FARM					
					

TITLE: FIGURE 2.3  
INDICATIVE WIND TURBINE FOUNDATION  
PLAN AND SECTION

306.30605	1387710
-----------	---------

<b>FOR INFORMATION</b>		<b>D</b>
SCALE: 1:200		
18599_DET_3004		



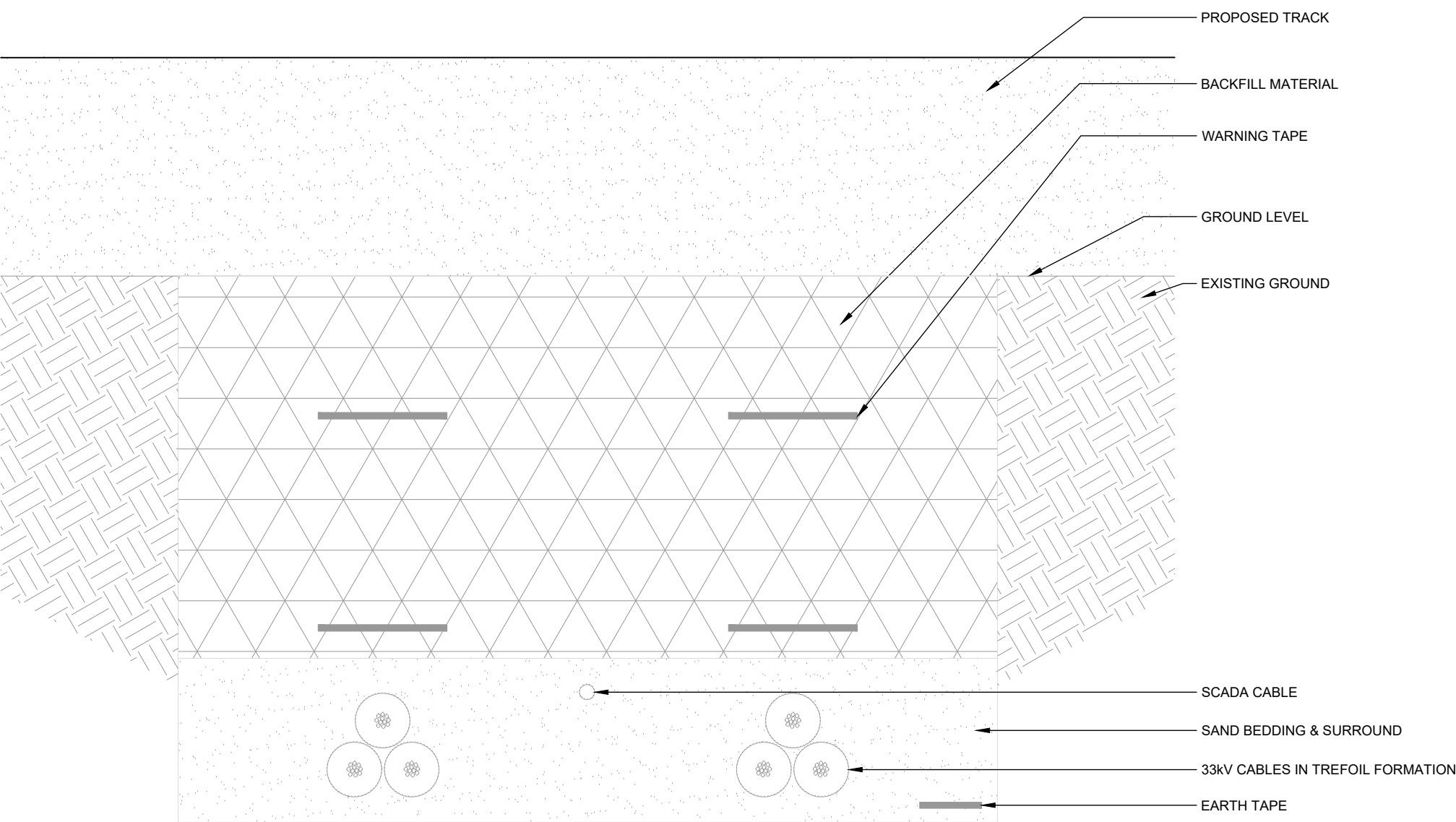

**INDICATIVE CABLE TRENCH AND  
TRACK CROSSING CROSS-SECTION**

**LEGAL:** NATURAL POWER CONSULTANTS LTD TAKES NO RESPONSIBILITY FOR THE ACCURACY OF DATA PROVIDED BY THIRD PARTIES.

**NOTES:**

1. THIS IS A INDICATIVE ARRANGEMENT ONLY AND NOT FOR CONSTRUCTION.

C	NOTES & TITLE UPDATED	AL	MB	JS	31/10/25
B	TITLE UPDATED	AL	MB	JS	28/08/25
A	INITIAL ISSUE	AL	MB	JS	13/05/25
REV	DESCRIPTION	BY	CH	APP	DATE

FOEL FACH WIND FARM



TITLE:  
FIGURE 2.4  
INDICATIVE CABLE TRENCH AND TRACK  
CROSSING CROSS-SECTION

306.30605 1387711

**FOR INFORMATION**

SCALE: NTS

18599\_DET\_3005

**C**

LEGAL: NATURAL POWER CONSULTANTS LTD TAKES NO RESPONSIBILITY FOR THE ACCURACY OF DATA PROVIDED BY THIRD PARTIES.

NOTES:

1. THIS IS AN INDICATIVE ARRANGEMENT ONLY AND NOT FOR CONSTRUCTION.
2. ATTENUATION BASIN, OR SIMILAR, WITH CAPACITY TO HOLD THE SAME VOLUME AS THE EMERGENCY WATER SUPPLY WOULD BE INCLUDED. THE SYSTEM WOULD HAVE THE ABILITY TO BE CONTAINED / VALVED OFF WHEN REQUIRED

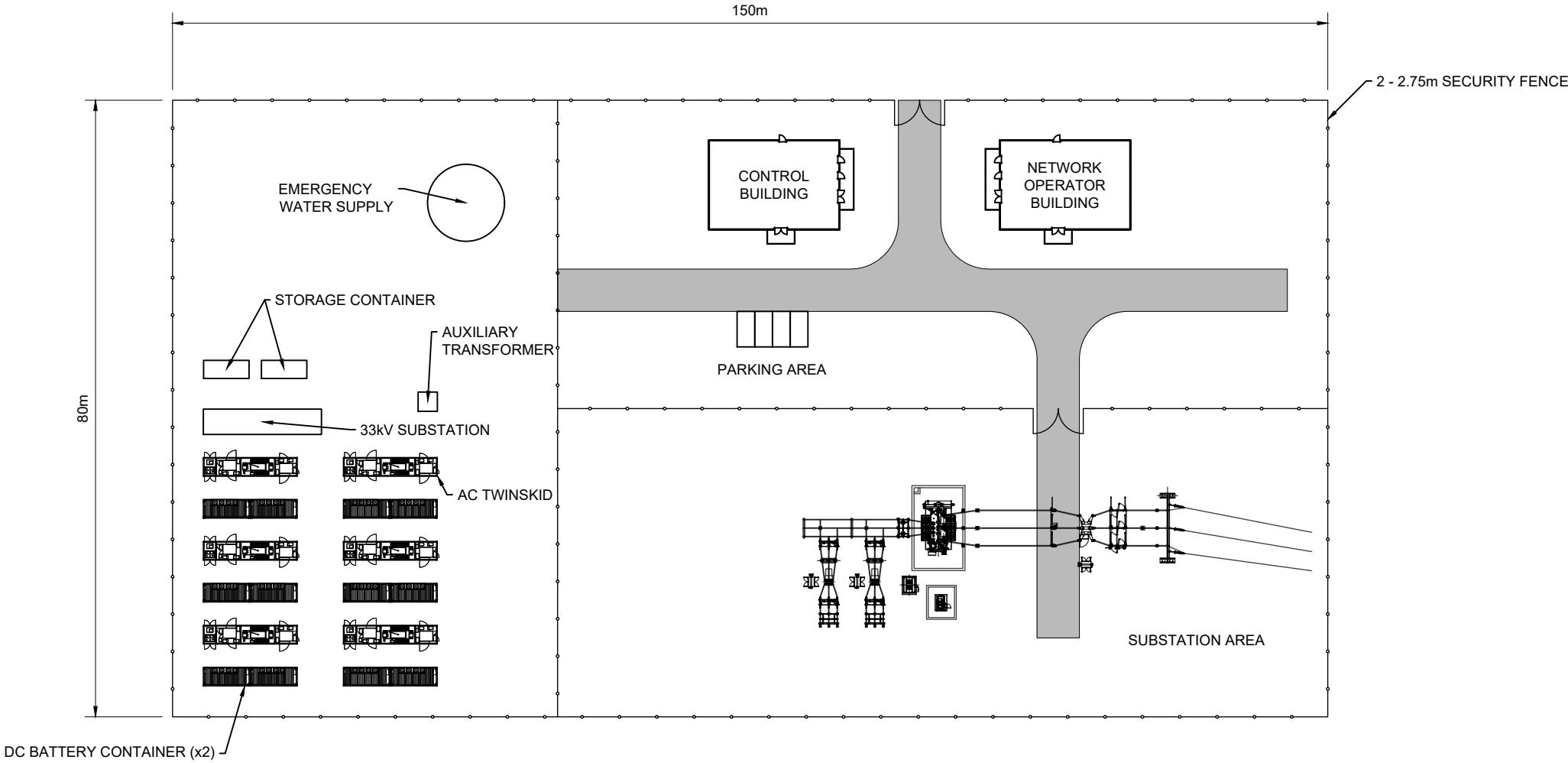

**INDICATIVE SUBSTATION, BESS AND  
CONTROL BUILDING PLAN**

SCALE 1:750

E	TITLE UPDATED	AL	MB	JS	28/08/25
D	WATER SUPPLY ADDED	AL	MB	JS	25/08/25
C	TITLE UPDATED	AL	MB	JS	25/06/25
B	LAYOUT PLAN AMENDED	AL	MB	JS	30/05/25
A	INITIAL ISSUE	AL	MB	JS	21/05/25
REV	DESCRIPTION	BY	CH	APP	DATE



TITLE:  
FIGURE 2.5  
INDICATIVE SUBSTATION, BESS  
AND CONTROL BUILDING PLAN

306.30605 1387712

**FOR INFORMATION**

SCALE: 1:750  
18599\_DET\_3006

**E**



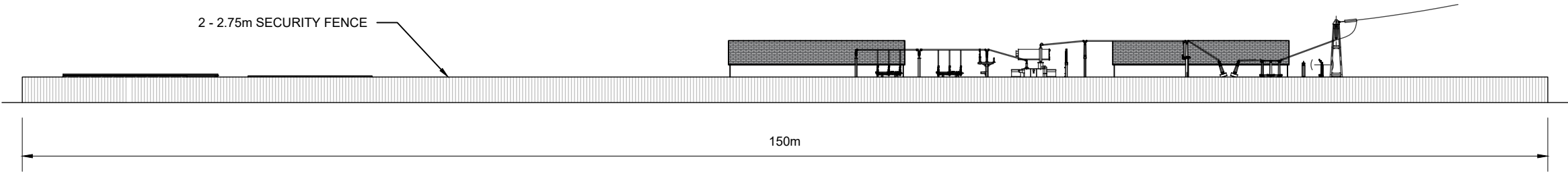

**COMPOUND FRONT ELEVATION**  
SCALE 1:500

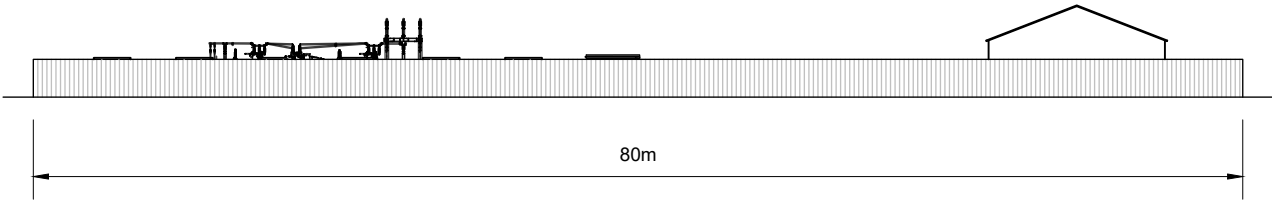

**COMPOUND SIDE ELEVATION**  
SCALE 1:500

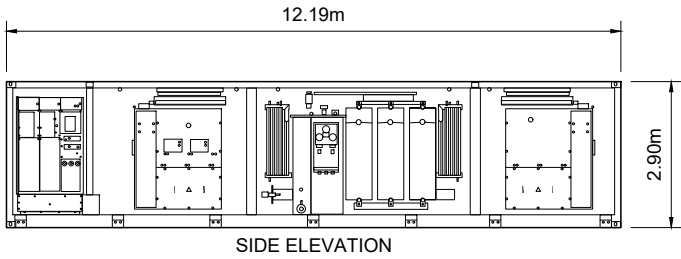

**AC TWINSKID**  
SCALE 1:150

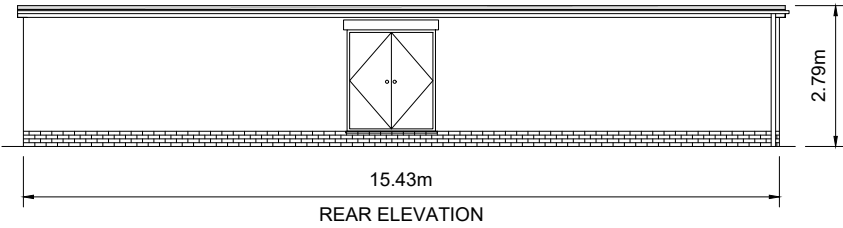
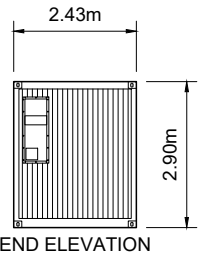

**33KV SUBSTATION**  
SCALE: 1:150

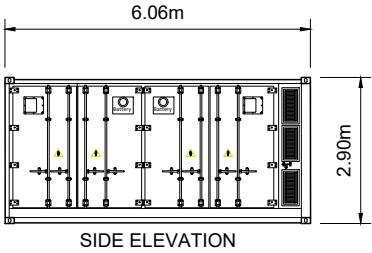

**DC BATTERY CONTAINER**  
SCALE 1:150

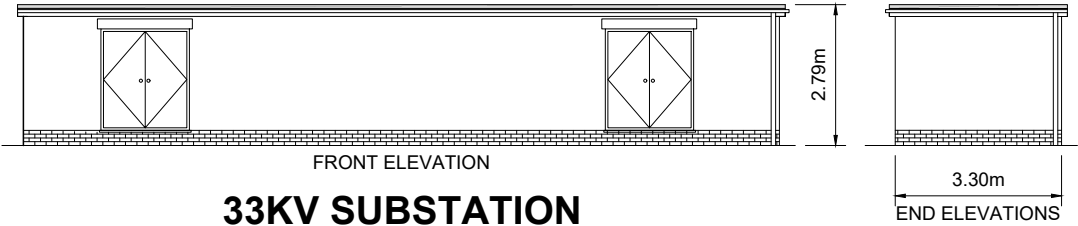
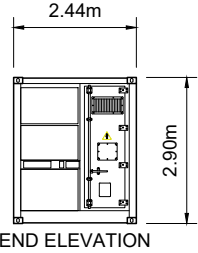

**LEGAL:** NATURAL POWER CONSULTANTS LTD TAKES NO RESPONSIBILITY FOR THE ACCURACY OF DATA PROVIDED BY THIRD PARTIES.

- NOTES:**
- THIS IS A TYPICAL ARRANGEMENT ONLY AND NOT FOR CONSTRUCTION.

D	TITLE UPDATED	AL	MB	JS	28/08/25
C	TITLE UPDATED	AL	MB	JS	25/06/25
B	ELEVATIONS ADDED	AL	MB	JS	30/05/25
A	INITIAL ISSUE	AL	MB	JS	21/05/25
REV	DESCRIPTION	BY	CH	APP	DATE

FOEL FACH WIND FARM					
<div><div></div><div></div><div></div><div></div></div>					

TITLE: FIGURE 2.6  
INDICATIVE SUBSTATION, BESS  
AND CONTROL BUILDING ELEVATIONS

306.30605	1387714
-----------	---------

**FOR INFORMATION**

SCALE: VARIOUS  
18599\_DET\_3007

**D**

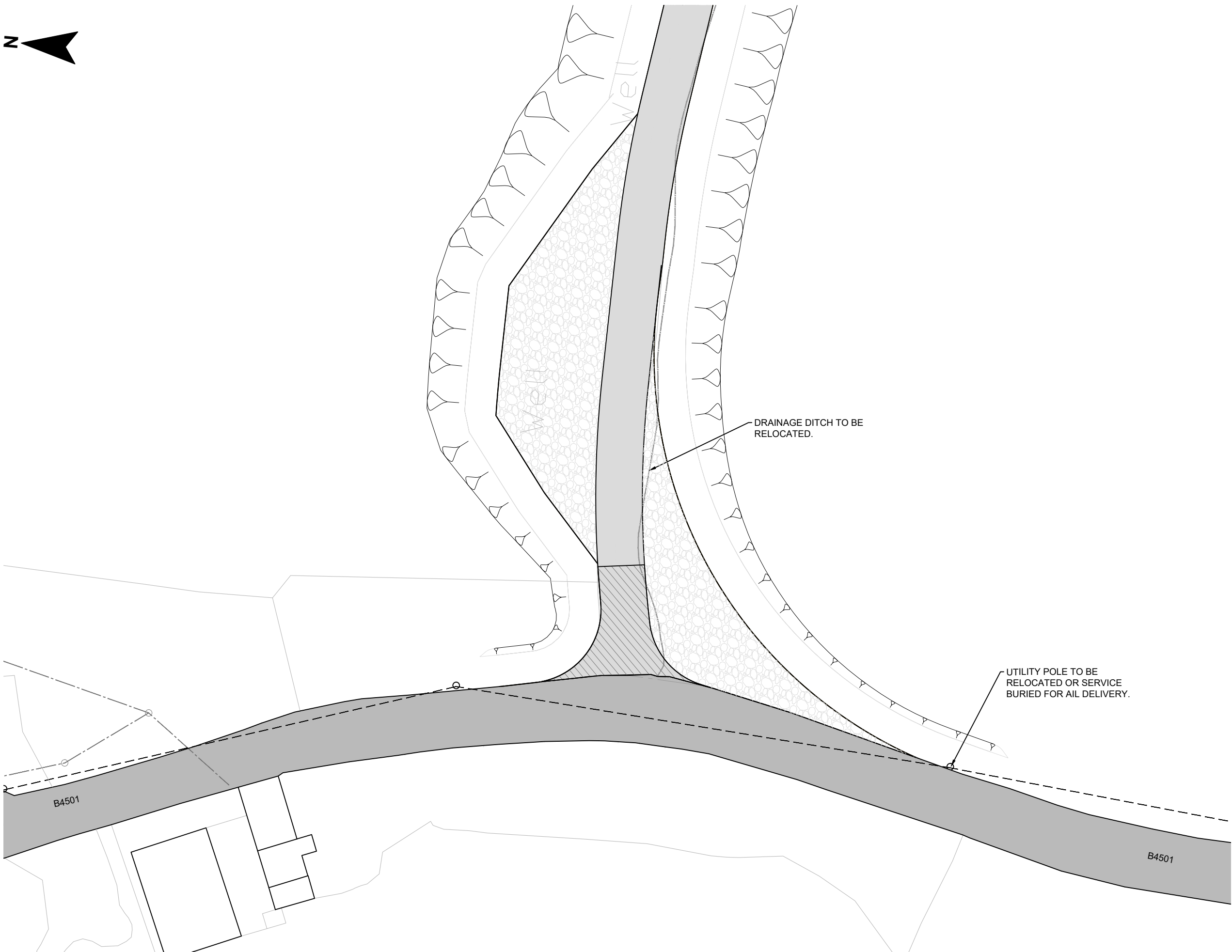

**SITE ENTRANCE ARRANGEMENT PLAN**  
SCALE 1:500

**LEGAL:** NATURAL POWER CONSULTANTS LTD TAKES NO RESPONSIBILITY FOR THE ACCURACY OF DATA PROVIDED BY THIRD PARTIES.

**COPYRIGHT:** REPRODUCED FROM ORDNANCE SURVEY DIGITAL MAP DATA © CROWN COPYRIGHT 2025. ALL RIGHTS RESERVED. ORDNANCE SURVEY LICENCE 100031673.

- NOTES:**
1. THIS DRAWING IS BASED UPON ORDNANCE SURVEY DATA.
  2. ACCESS JUNCTION LAYOUT AND DESIGN IS INDICATIVE. FULL DETAILS FOR CONSTRUCTION SHALL BE DEVELOPED CONSIDERING TOPOGRAPHICAL SURVEY, GROUND CONDITIONS, DRAINAGE AND DETAILED SITE DESIGN PROPOSALS.
  3. WELLS ARE REDUNDANT AND ARE TO BE REMOVED AND SEALED AS NECESSARY PRIOR TO WORKS COMMENCING.

- KEY:**
- PROPOSED TRACK
  - EXISTING ROAD
  - PROPOSED BOUND SURFACE
  - TEMPORARY WIDENING FOR AIL DELIVERY
  - OVERHEAD LINES
  - UNDERGROUND ELECTRICAL CABLES
  - CUT MATERIAL
  - DRAINAGE DITCH

C	TITLE UPDATED	AL	MB	JS	28/08/25
B	NOTES UPDATED	AL	MB	JS	15/08/25
A	INITIAL ISSUE	MH	MB	JS	09/05/25
REV	DESCRIPTION	BY	CH	APP	DATE

FOEL FACH WIND FARM

**TITLE:**  
FIGURE 2.7  
INDICATIVE SITE ENTRANCE  
ARRANGEMENT

306.306051387715

FOR INFORMATION

SCALE:1:500

18599\_DET\_3008

C



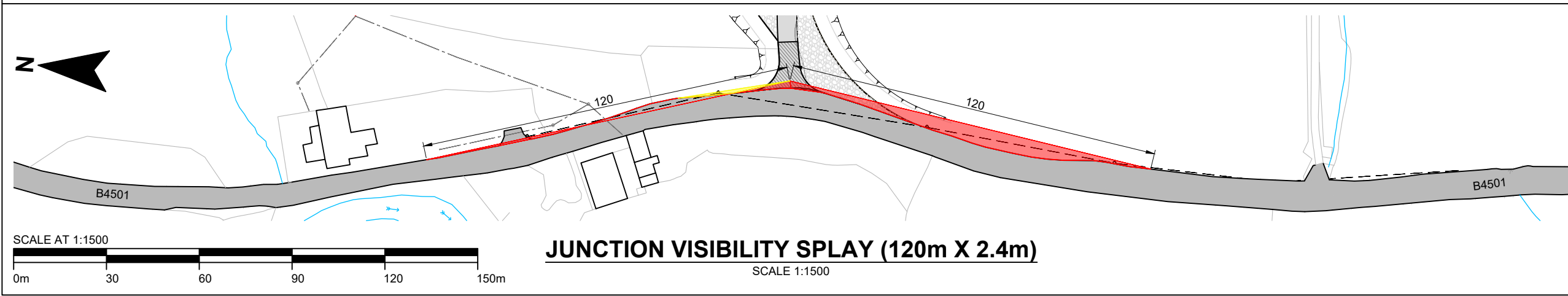
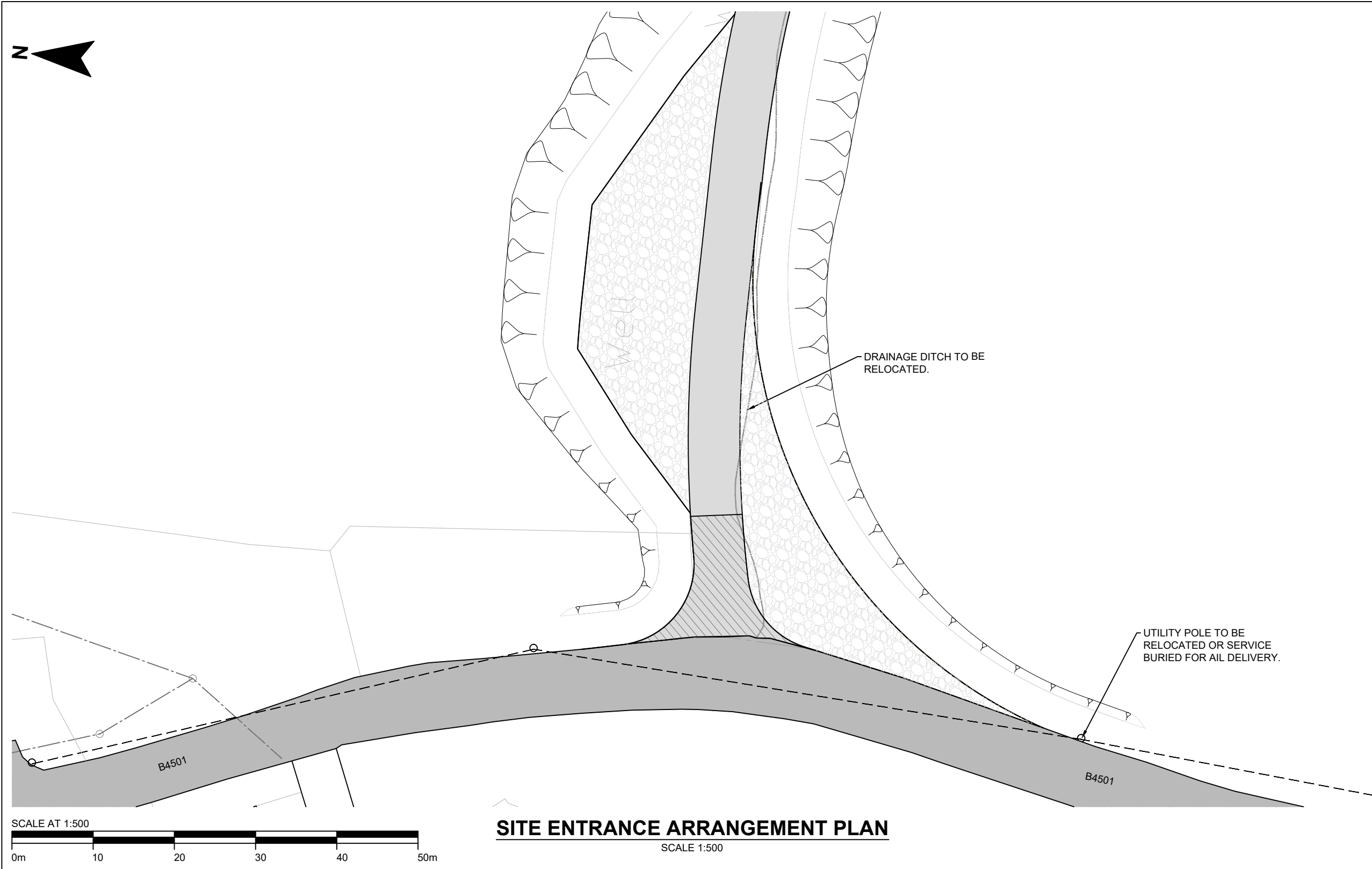

**LEGAL:** NATURAL POWER CONSULTANTS LTD TAKES NO RESPONSIBILITY FOR THE ACCURACY OF DATA PROVIDED BY THIRD PARTIES.

**COPYRIGHT:** REPRODUCED FROM ORDNANCE SURVEY DIGITAL MAP DATA © CROWN COPYRIGHT 2025. ALL RIGHTS RESERVED. ORDNANCE SURVEY LICENCE 100031673.

- NOTES:**
1. THIS DRAWING SHOULD BE READ IN CONJUNCTION WITH ALL OTHER NATURAL POWER ENGINEERING DRAWINGS.
  2. ALL DIMENSIONS ARE IN METRES UNLESS OTHERWISE STATED.
  3. THIS DRAWING IS BASED UPON ORDNANCE SURVEY DATA.
  4. THE AREA WITHIN THE VISIBILITY SPLAY IS TO BE CLEARED, AS INDICATED AND ANY TREES, HEDGES & SIGNS SHALL BE REMOVED IN ORDER TO GAIN THE REQUIRED VISIBILITY SPLAY WHICH IS 120m X 2.4m.
  5. VISIBILITY SPLAY HAS BEEN ASSESSED USING TAN 18: TRANSPORT, ON A SPEED LIMIT OF 40mph. ON THIS BASIS A DISTANCE OF 120m X 2.4m IS REQUIRED.
  6. ACCESS JUNCTION LAYOUT AND DESIGN IS INDICATIVE. FULL DETAILS FOR CONSTRUCTION SHALL BE DEVELOPED CONSIDERING TOPOGRAPHICAL SURVEY, GROUND CONDITIONS, DRAINAGE AND DETAILED SITE DESIGN PROPOSALS.
  7. WELLS ARE REDUNDANT AND ARE TO BE REMOVED AND SEALED AS NECESSARY PRIOR TO WORKS COMMENCING.

**KEY:**

	PROPOSED TRACK
	PROPOSED BOUND SURFACE
	EXISTING ROAD
	TEMPORARY WIDENING FOR CONSTRUCTION PHASE
	OVERHEAD LINES
	UNDERGROUND ELECTRICAL CABLES
	CUT MATERIAL
	DRAINAGE DITCH
	VISIBILITY SPLAY (120 m x 2.4 m)
	VISIBILITY SPLAY - ADDITIONAL AREA TANGENTIAL TO EDGE OF CARRIAGEWAY.

D	SPLAY UPDATED	AL	MB	JS	02/11/25
C	TITLE UPDATED	AL	MB	JS	28/08/25
B	DRAWING UPDATED	AL	MB	JS	25/06/25
A	INITIAL ISSUE	MH	MB	JS	09/05/25
REV	DESCRIPTION	BY	CH	APP	DATE

**FOEL FACH WIND FARM**

**TITLE:** FIGURE 2.8  
INDICATIVE SITE ENTRANCE  
AND JUNCTION VISIBILITY SPLAY

306.30605	1387716
<b>FOR INFORMATION</b>	
SCALE: VARIOUS	
18599_DET_3009	
<b>D</b>	

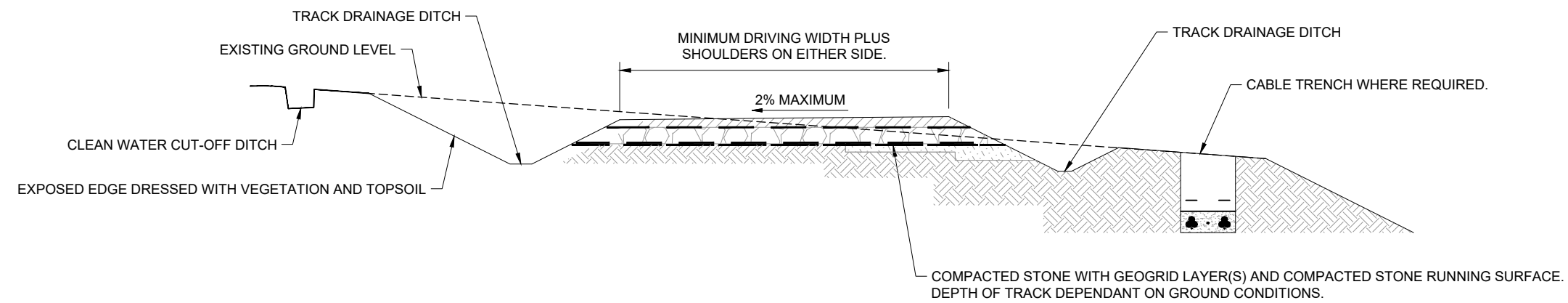

INDICATIVE NEW ACCESS TRACK CROSS-SECTION

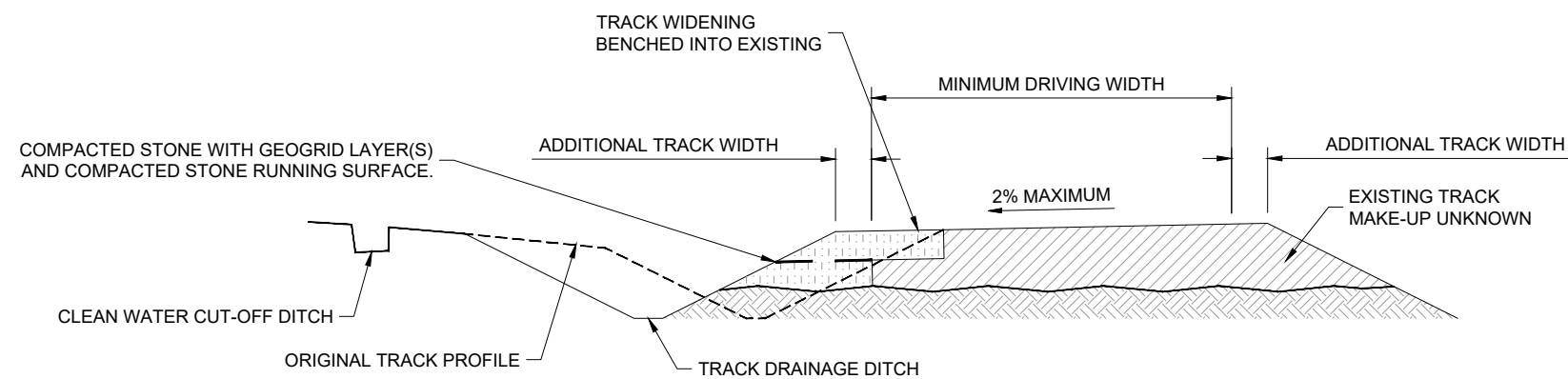

INDICATIVE EXISTING ACCESS TRACK WIDENING CROSS-SECTION

LEGAL: NATURAL POWER CONSULTANTS LTD TAKES NO RESPONSIBILITY FOR THE ACCURACY OF DATA PROVIDED BY THIRD PARTIES.

NOTES:

1. THIS IS A INDICATIVE ARRANGEMENT ONLY AND NOT FOR CONSTRUCTION.

C	NOTES & TITLE UPDATED	AL	MB	JS	31/10/25
B	TITLE UPDATED	AL	MB	JS	28/08/25
A	INITIAL ISSUE	AL	MB	JS	13/05/25
REV	DESCRIPTION	BY	CH	APP	DATE

FOEL FACH WIND FARM



TITLE: FIGURE 2.9  
INDICATIVE ACCESS TRACK  
CROSS-SECTION

306.30605

1387717

FOR INFORMATION

SCALE: NTS

18599\_DET\_3010

C



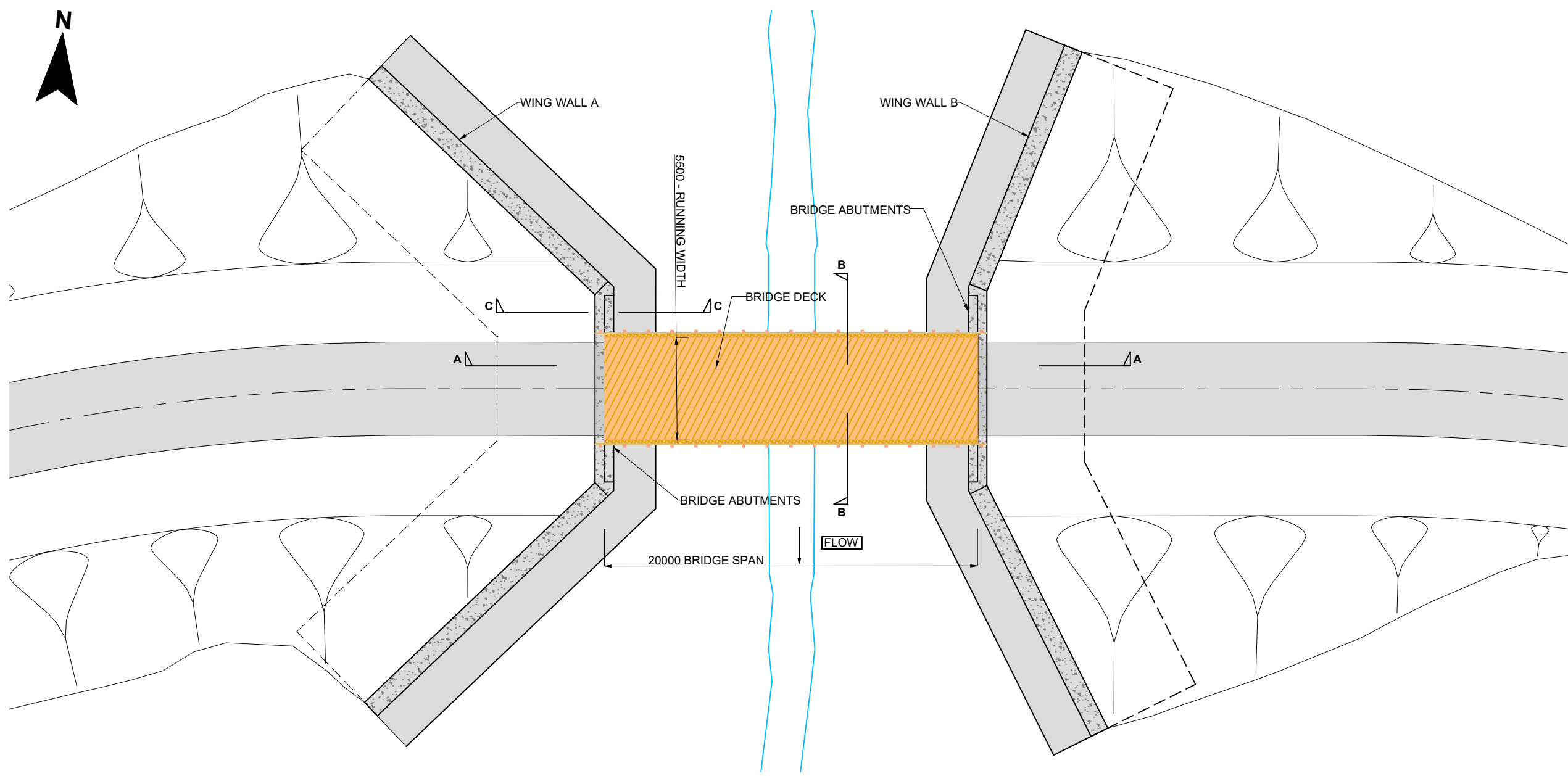

**INDICATIVE BRIDGE LAYOUT PLAN**

SCALE 1:250

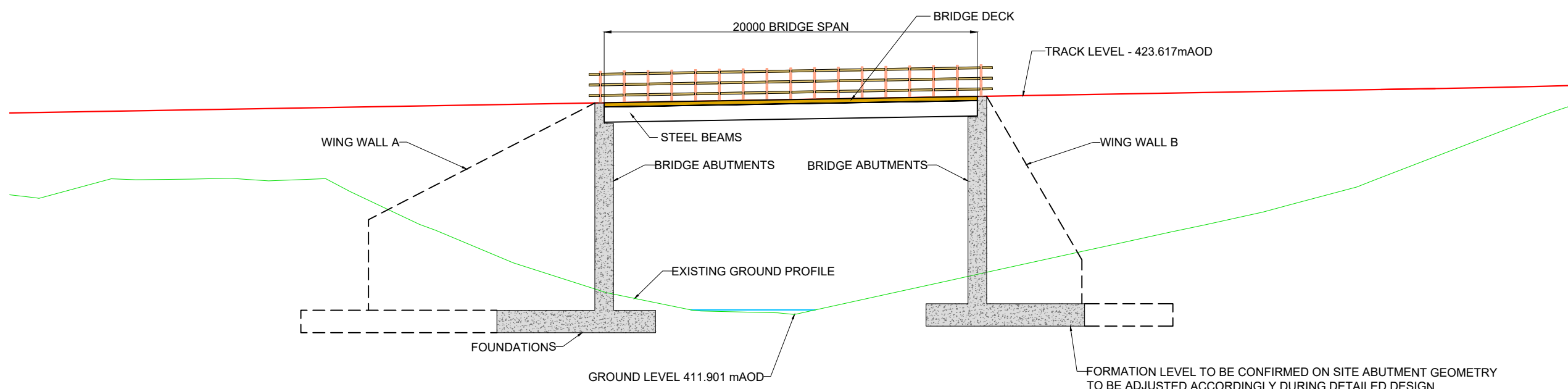

**BRIDGE CROSS-SECTION A-A**

SCALE 1:250



**LEGAL:** NATURAL POWER CONSULTANTS LTD TAKES NO RESPONSIBILITY FOR THE ACCURACY OF DATA PROVIDED BY THIRD PARTIES.

- NOTES:**
1. ALL DIMENSIONS ARE IN MILLIMETRES UNLESS OTHERWISE STATED.
  2. THIS DRAWING IS BASED UPON DTM TOPOGRAPHICAL DATA. NATURAL POWER TAKES NO RESPONSIBILITY FOR THE ACCURACY OF THIS DATA.
  3. THIS IS A CONCEPTUAL DESIGN ONLY AND NOT FOR CONSTRUCTION
  4. FOR BRIDGE CROSS-SECTION, AND ABUTMENT WALL DETAILS SEE DRAWING 18599\_DET\_3012.
  5. THIS DRAWINGS SHOULD BE READ IN CONJUNCTION WITH ALL OTHER NATURAL POWER ENGINEERING DRAWINGS.

- KEY:**
- PROPOSED ACCESS TRACK
  - EARTHWORKS FILL MATERIAL
  - INDICATIVE RIVER LOCATION
  - CONCRETE REINFORCED ABUTMENTS AND WING WALLS
  - HARDWOOD TIMBER BRIDGE DECK
  - EXISTING GROUND PROFILE
  - PROPOSED GROUND PROFILE

B	TITLE UPDATED	AL	MB	JS	28/08/25
A	INITIAL ISSUE	GC	JL	TN	07/05/25
REV	DESCRIPTION	BY	CH	APP	DATE

FOEL FACH WIND FARM



**TITLE:** FIGURE 2.10  
INDICATIVE BRIDGE LAYOUT PLAN  
& BRIDGE CROSS-SECTION A-A

306.30605 1387718

**FOR INFORMATION**  
SCALE:1:250  
18599\_DET\_3011 **B**

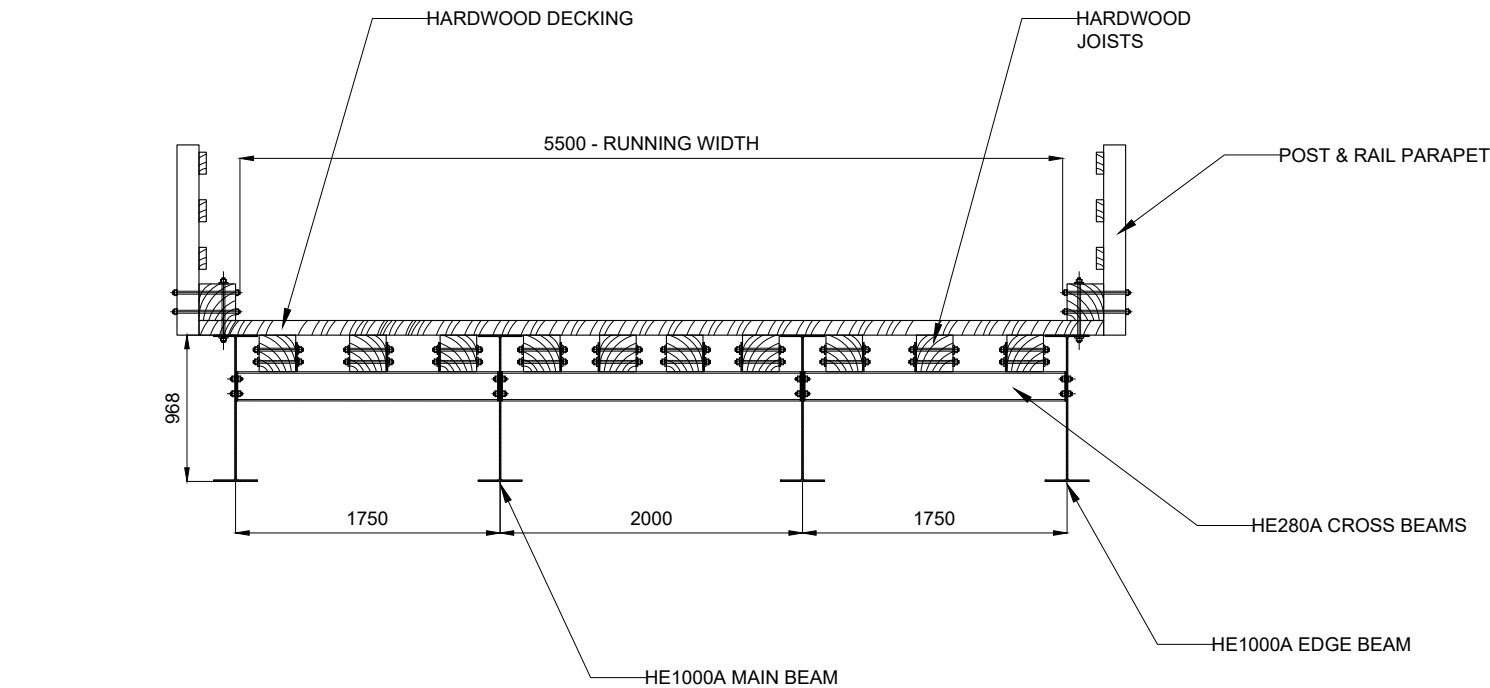

**BRIDGE DECK CROSS-SECTION B-B**  
SCALE 1:50

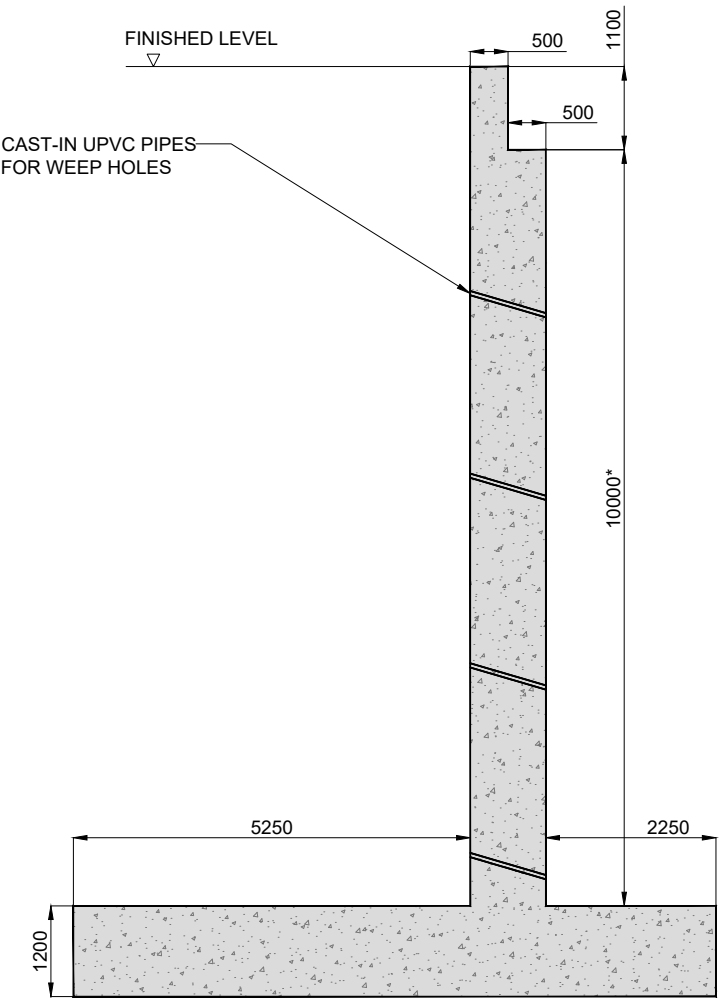

**BRIDGE DECK CROSS-SECTION C-C**  
SCALE 1:100

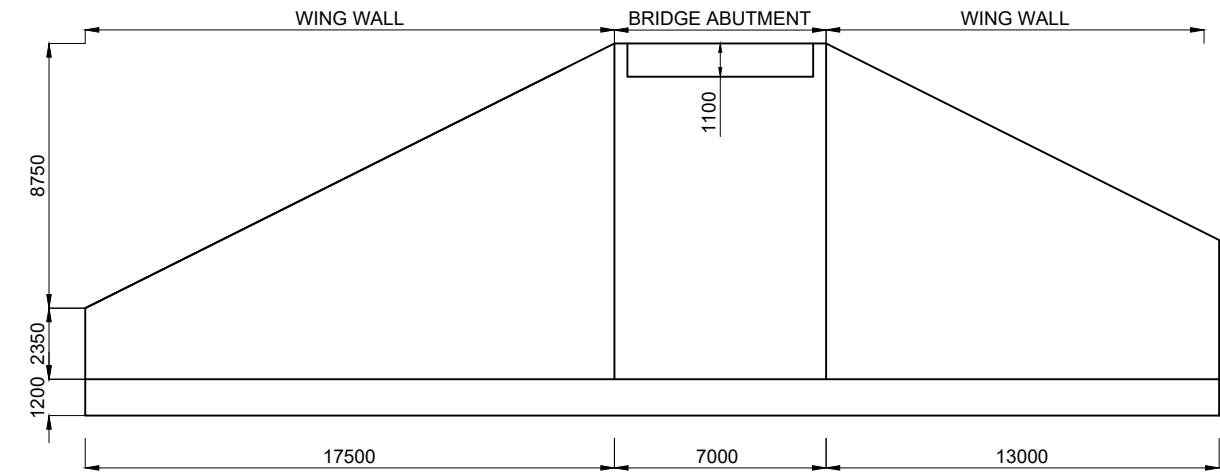

**BRIDGE ABUTMENT A - ELEVATION**  
SCALE 1:250

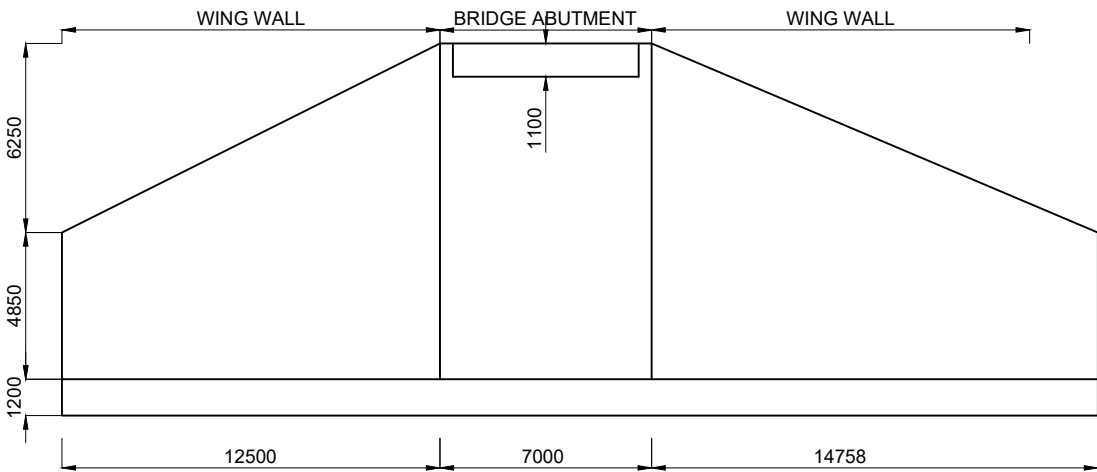

**BRIDGE ABUTMENT B - ELEVATION**  
SCALE 1:250

**LEGAL:** NATURAL POWER CONSULTANTS LTD TAKES NO RESPONSIBILITY FOR THE ACCURACY OF DATA PROVIDED BY THIRD PARTIES.

**NOTES:**

1. ALL DIMENSIONS ARE IN MILLIMETRES UNLESS OTHERWISE STATED.
2. THIS DRAWING IS BASED UPON DTM TOPOGRAPHICAL DATA. NATURAL POWER TAKES NO RESPONSIBILITY FOR THE ACCURACY OF THIS DATA.
3. THIS IS A CONCEPTUAL DESIGN ONLY AND NOT FOR CONSTRUCTION
4. FOR BRIDGE PLAN DETAILS SEE DRAWING 18599\_DET\_3011.
5. THIS DRAWINGS SHOULD BE READ IN CONJUNCTION WITH ALL OTHER NATURAL POWER ENGINEERING DRAWINGS.

**KEY:**

 CONCRETE REINFORCED ABUTMENTS AND WING WALLS

B	TITLE UPDATED	AL	MB	JS	28/08/25
A	INITIAL ISSUE	GC	JL	TN	07/05/25
REV	DESCRIPTION	BY	CH	APP	DATE

FOEL FACH WIND FARM



TITLE: FIGURE 2.11  
INDICATIVE BRIDGE CROSS-SECTIONS

306.30605 1387719

**FOR INFORMATION**

SCALE: VARIOUS

18599\_DET\_3012

**B**



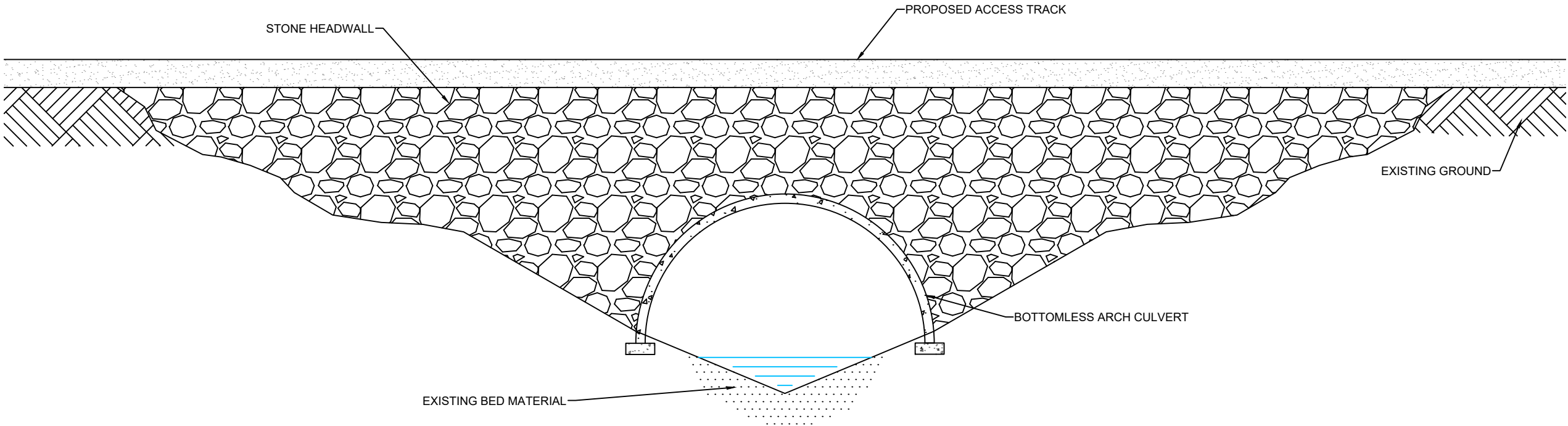

**INDICATIVE WATERCOURSE CROSSING**

**LEGAL:** NATURAL POWER CONSULTANTS LTD TAKES NO RESPONSIBILITY FOR THE ACCURACY OF DATA PROVIDED BY THIRD PARTIES.

- NOTES:**
1. THIS IS A INDICATIVE ARRANGEMENT ONLY AND NOT FOR CONSTRUCTION.

C	NOTES & TITLE UPDATED	AL	MB	JS	31/10/25
B	TITLE UPDATED	AL	MB	JS	28/08/25
A	INITIAL ISSUE	AL	MB	JS	16/05/25
REV	DESCRIPTION	BY	CH	APP	DATE

FOEL FACH WIND FARM

Coriolis Energy

ESB Energy for generations

natural power

environment RSK  
ASSESSMENT • MANAGEMENT • CONSULTANTS

TITLE:  
FIGURE 2.12  
INDICATIVE WATERCOURSE CROSSING

306.30605	1387720
FOR INFORMATION	
SCALE: NTS	
18599_DET_3013	C

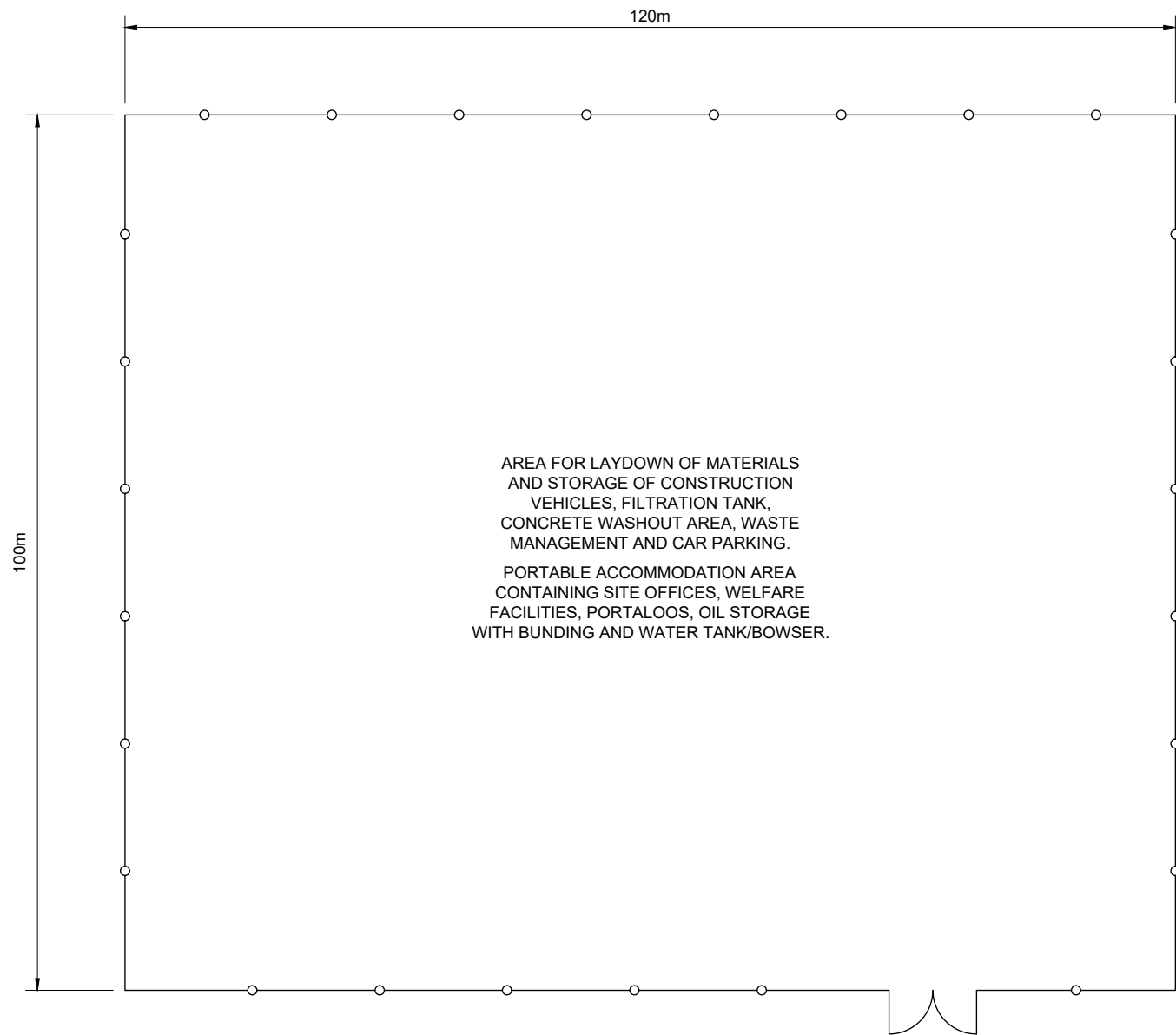

**INDICATIVE CONSTRUCTION COMPOUND PLAN**

SCALE 1:750

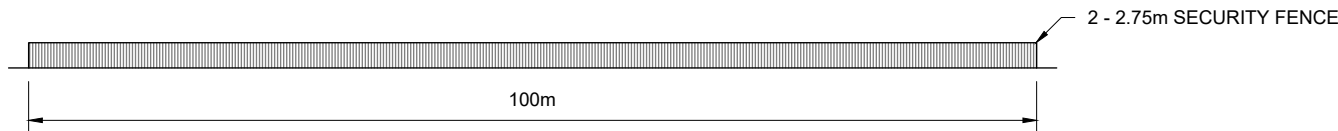

**SIDE ELEVATION**

SCALE 1:750



**LEGAL:** NATURAL POWER CONSULTANTS LTD TAKES NO RESPONSIBILITY FOR THE ACCURACY OF DATA PROVIDED BY THIRD PARTIES.

**NOTES:**

1. THIS IS A TYPICAL ARRANGEMENT ONLY AND NOT FOR CONSTRUCTION.

C	TITLE & LAYOUT UPDATED	AL	MB	JS	28/08/25
B	BLADE LAYDOWN AREA REMOVED	AL	MB	JS	30/05/25
A	INITIAL ISSUE	AL	MB	JS	21/05/25
REV	DESCRIPTION	BY	CH	APP	DATE

FOEL FACH WIND FARM					
					

TITLE: FIGURE 2.13  
INDICATIVE CONSTRUCTION COMPOUND  
PLAN AND ELEVATION

306.30605	1387721
-----------	---------

**FOR INFORMATION**

SCALE: 1:750  
18599\_DET\_3014

**C**



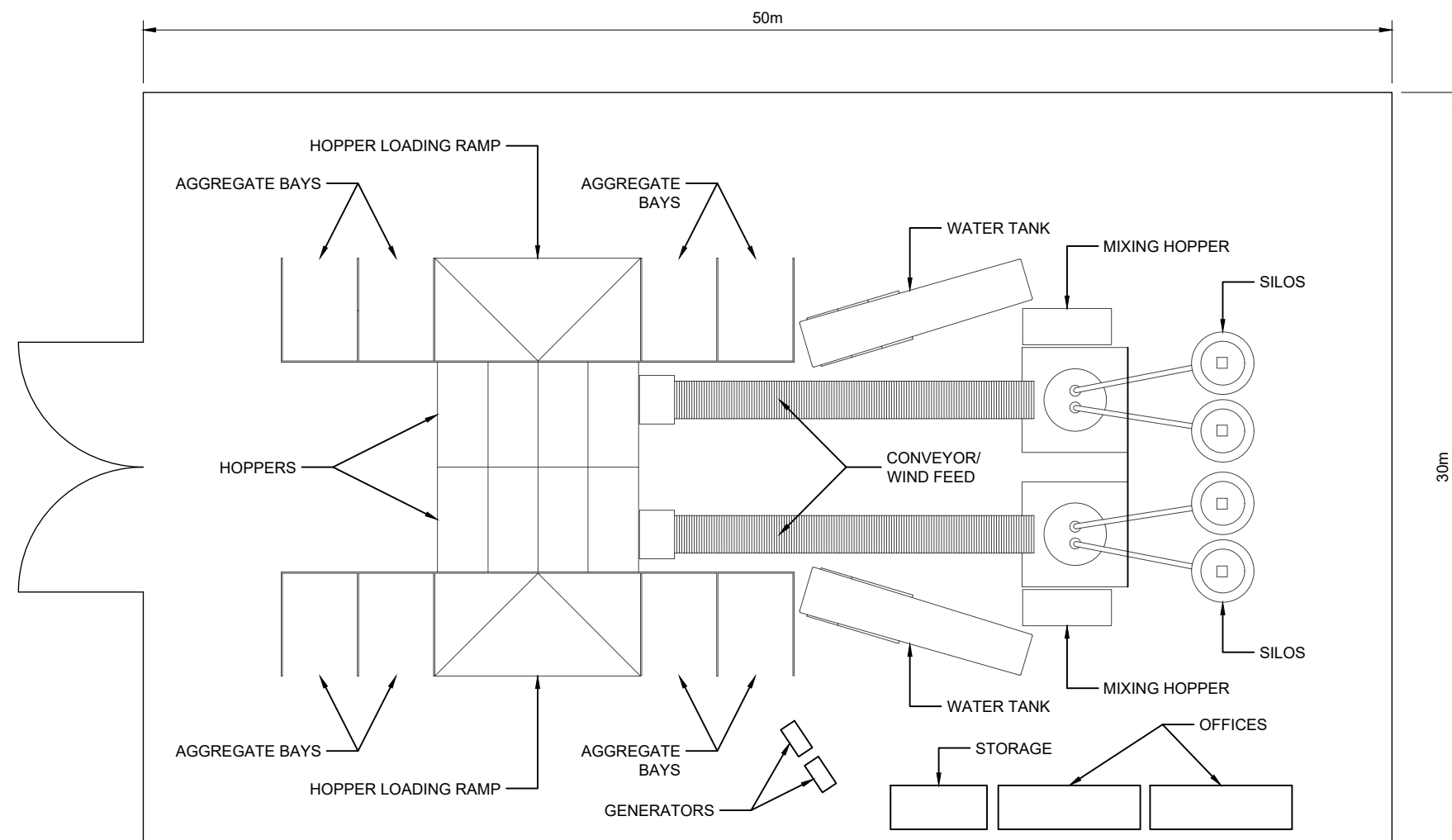

**INDICATIVE BATCHING PLANT**  
SCALE 1:250

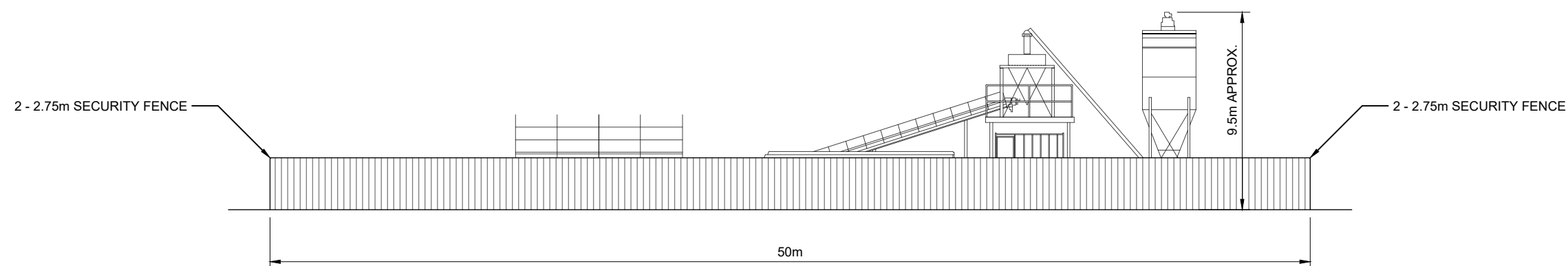

**FRONT ELEVATION**  
SCALE 1:250

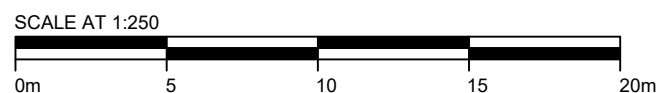

**LEGAL:** NATURAL POWER CONSULTANTS LTD TAKES NO RESPONSIBILITY FOR THE ACCURACY OF DATA PROVIDED BY THIRD PARTIES.

**NOTES:**

1. THIS IS A TYPICAL ARRANGEMENT ONLY AND NOT FOR CONSTRUCTION.

C	TITLE UPDATED	AL	MB	JS	28/08/25
B	TITLE UPDATED	AL	MB	JS	25/06/25
A	INITIAL ISSUE	GC	MB	JS	30/05/25
REV	DESCRIPTION	BY	CH	APP	DATE

FOEL FACH WIND FARM



TITLE: FIGURE 2.14  
INDICATIVE BATCHING PLANT

306.30605 1387722

**FOR INFORMATION**

SCALE: 1:250

18599\_DET\_3015

**C**

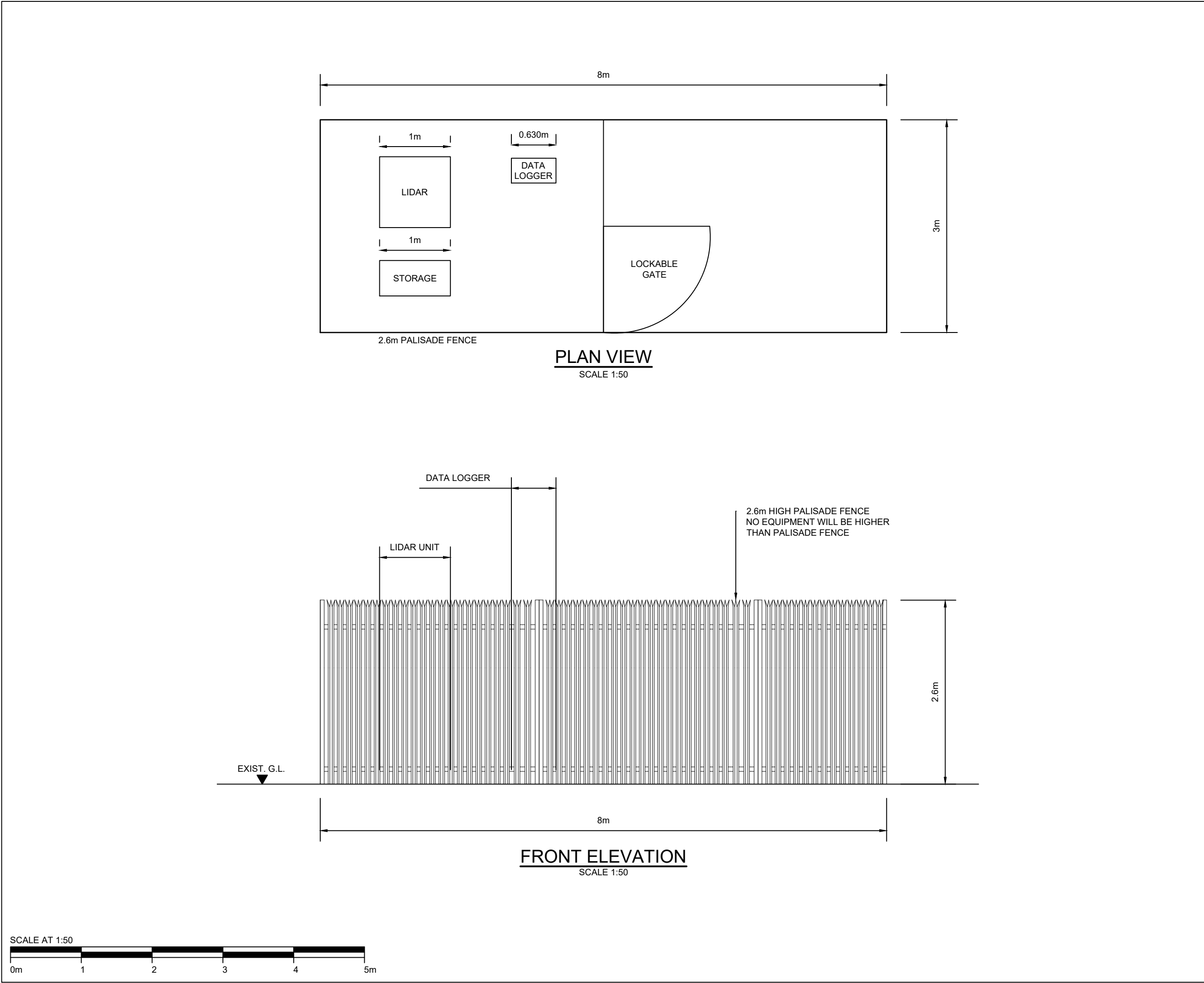

LEGAL: NATURAL POWER CONSULTANTS LTD TAKES NO RESPONSIBILITY FOR THE ACCURACY OF DATA PROVIDED BY THIRD PARTIES.

- NOTES:**
- THIS IS A TYPICAL ARRANGEMENT ONLY AND NOT FOR CONSTRUCTION.

B	TITLE UPDATED	AL	MB	JS	28/08/25
A	INITIAL DRAWING	AL	MB	JS	30/05/25
REV	DESCRIPTION	BY	CH	APP	DATE

FOEL FACH WIND FARM



TITLE: FIGURE 2.15  
INDICATIVE LIDAR COMPOUND  
PLAN AND ELEVATION

306.30605	1387723
-----------	---------

FOR INFORMATION

SCALE: 1:50



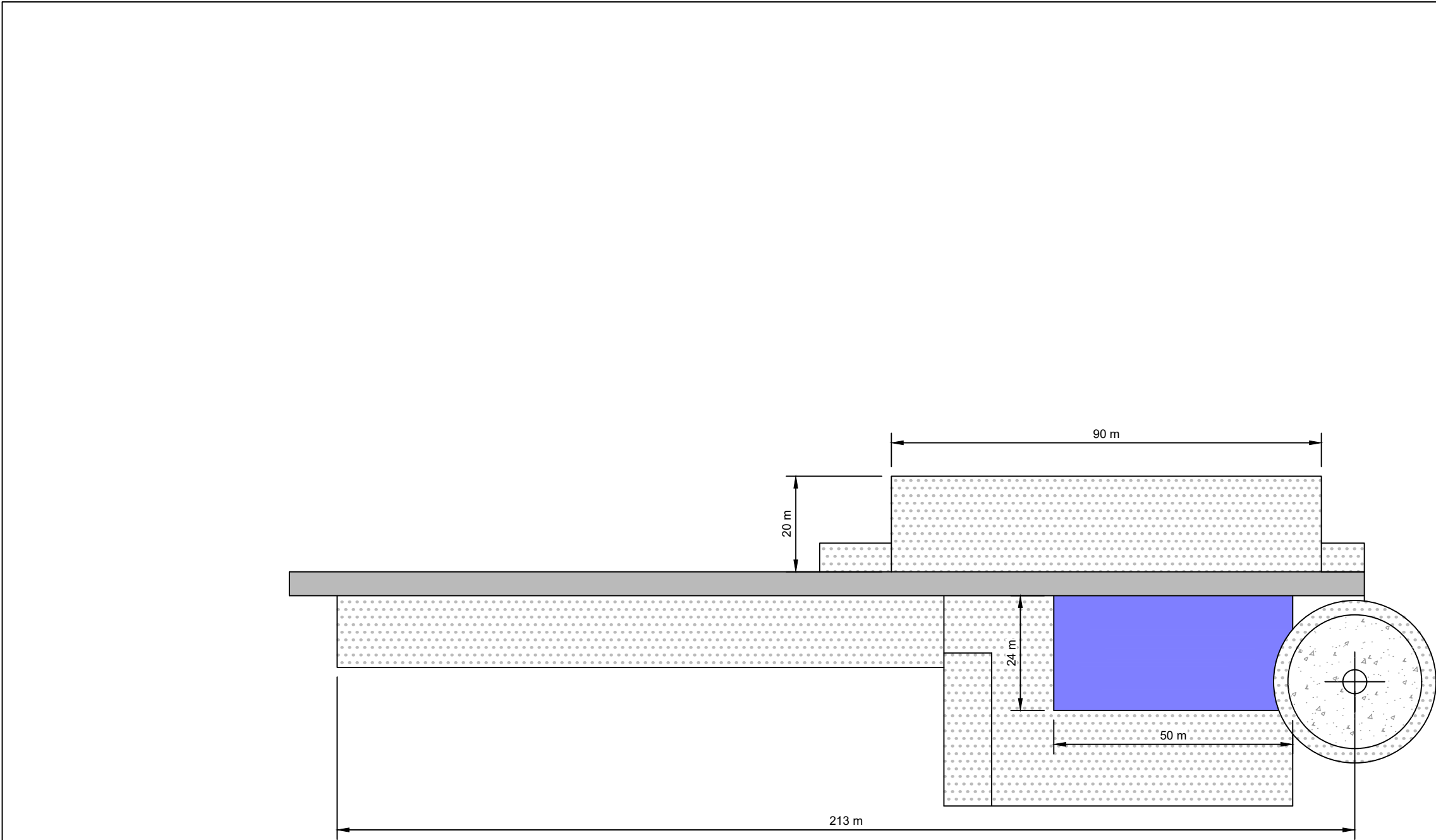

18599\_DET\_3016

B



LEGAL: NATURAL POWER CONSULTANTS LTD TAKES NO RESPONSIBILITY FOR THE ACCURACY OF DATA PROVIDED BY THIRD PARTIES.

- NOTES:**
1. ALL DIMENSIONS ARE IN METRES UNLESS OTHERWISE STATED.
  2. THIS IS AN INDICATIVE ARRANGEMENT ONLY AND NOT FOR CONSTRUCTION.

- KEY:**
-  WIND TURBINE
  -  TRACK
  -  CRANE PAD - PERMANENT
  -  WORKING AREA - TEMPORARY
  -  FOUNDATION

B	TITLE UPDATED	AL	MB	JS	28/08/25
A	INITIAL DRAWING	AL	MB	JS	06/06/25
REV	DESCRIPTION	BY	CH	APP	DATE

FOEL FACH WIND FARM



TITLE:  
FIGURE 2.16  
INDICATIVE TURBINE HARDSTAND

306.306051387943

**FOR INFORMATION**

SCALE: 1:1000

18599\_DET\_3017

**B**



LEGAL: NATURAL POWER CONSULTANTS LTD TAKES NO RESPONSIBILITY FOR THE ACCURACY OF DATA PROVIDED BY THIRD PARTIES.

NOTES:

1. THIS IS AN INDICATIVE ARRANGEMENT ONLY AND NOT FOR CONSTRUCTION.

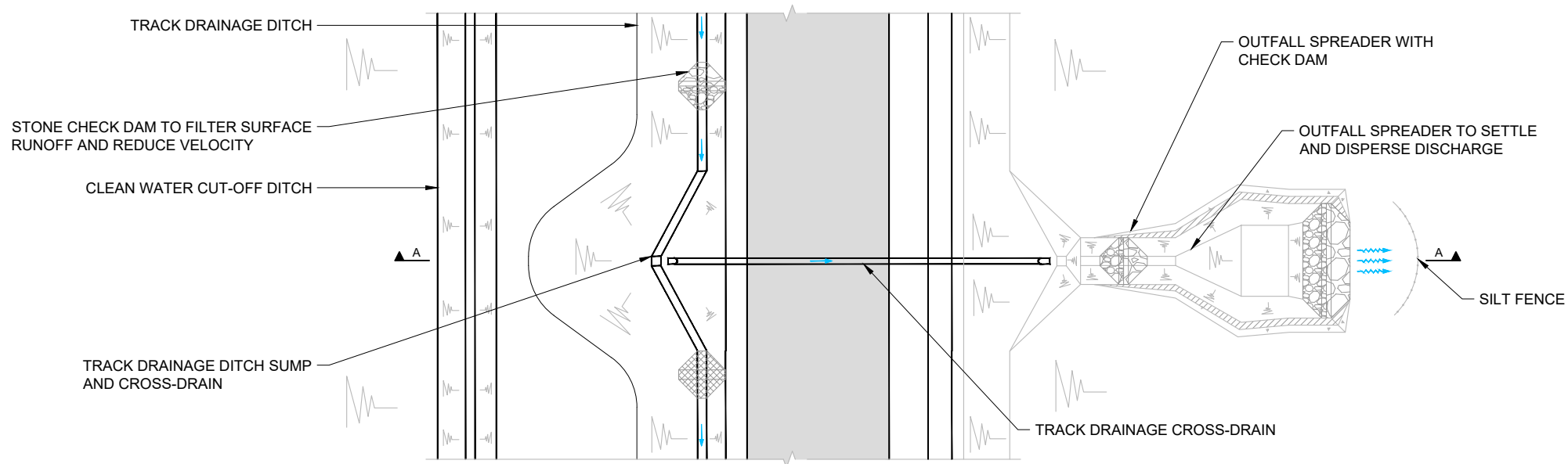

INDICATIVE ACCESS TRACK DRAINAGE PLAN

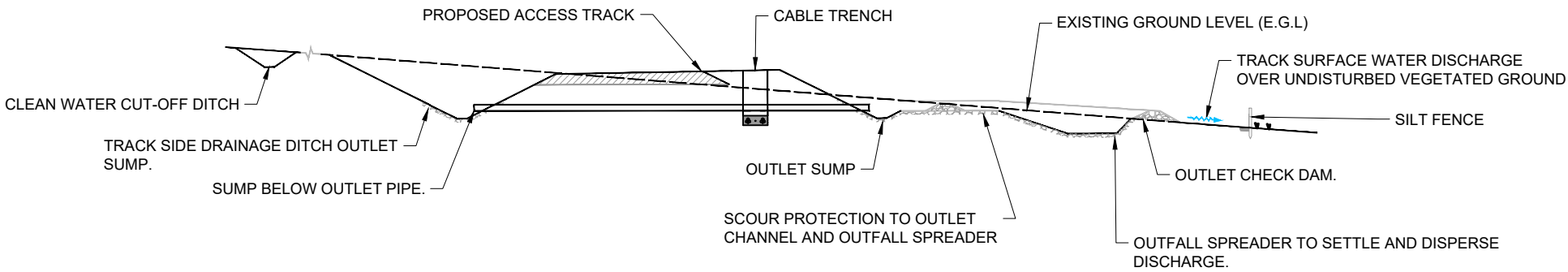

SECTION A-A

B	TITLE UPDATED	AL	MB	JS	03/11/25
A	INITIAL ISSUE	AL	MB	JS	29/08/25
REV	DESCRIPTION	BY	CH	APP	DATE

FOEL FACH WIND FARM



TITLE: FIGURE 2.17  
INDICATIVE ACCESS TRACK DRAINAGE  
DETAIL

306.30605 1387944

FOR INFORMATION

SCALE: NTS  
18599\_DET\_3018

B

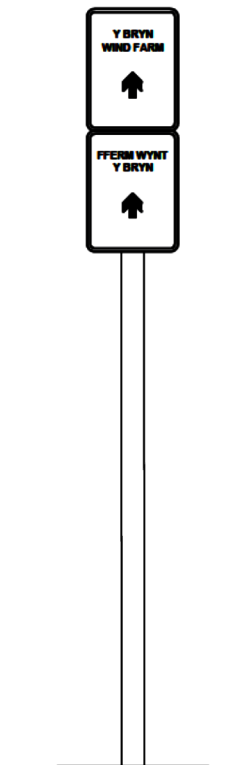

FRONT ELEVATION VIEW  
DOUBLE SIGN

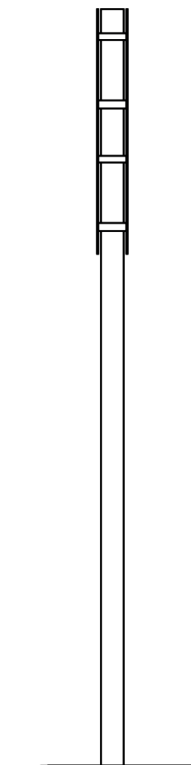

SIDE ELEVATION VIEW  
DOUBLE SIGN  
BOTH SIDES

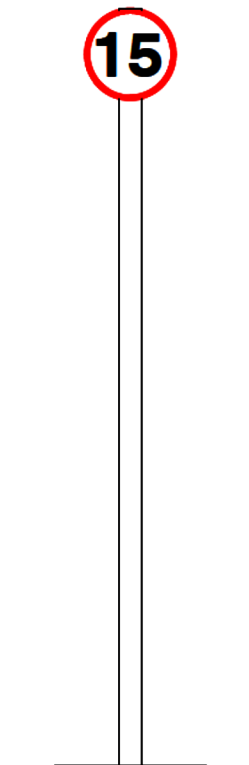

FRONT ELEVATION VIEW  
SINGLE ROUND SIGN

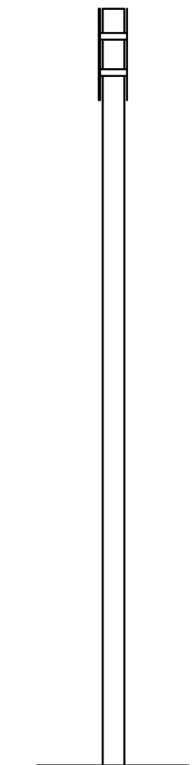

SIDE ELEVATION VIEW  
SINGLE ROUND SIGN  
BOTH SIDES

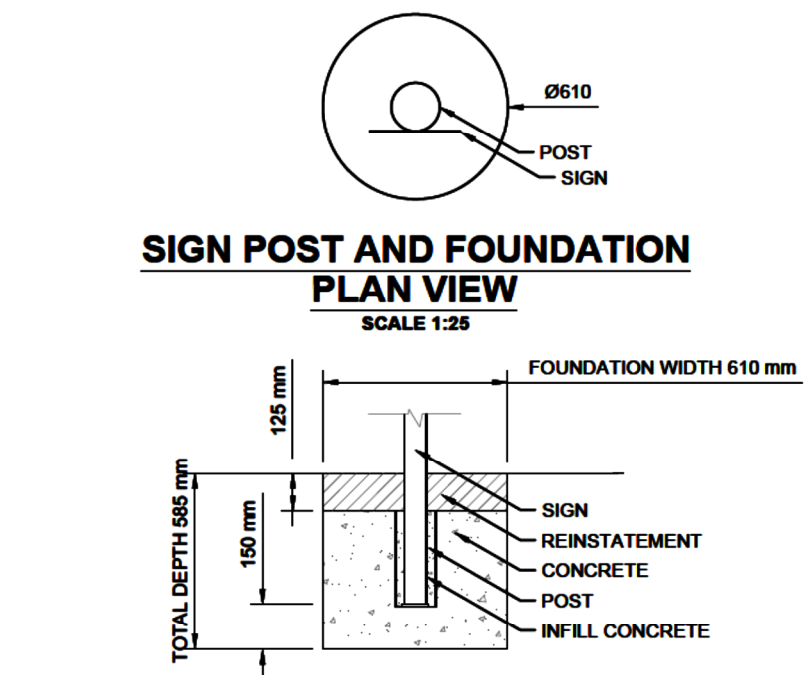

SIGN POST AND FOUNDATION  
PLAN VIEW  
SCALE 1:25

SIGN POST FOUNDATION AND BASE FIXING  
DETAIL VIEW  
SCALE 1:25

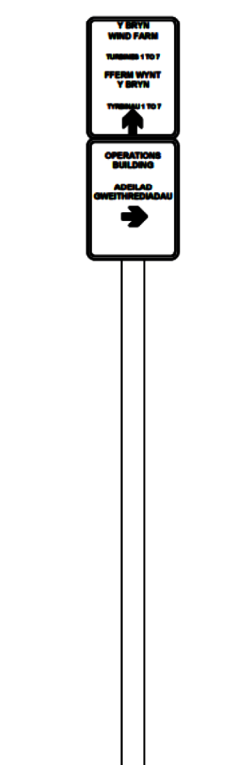

FRONT ELEVATION VIEW  
DOUBLE SIGN

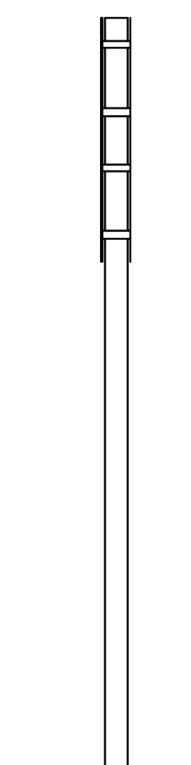

SIDE ELEVATION VIEW  
DOUBLE SIGN  
ONE SIDE

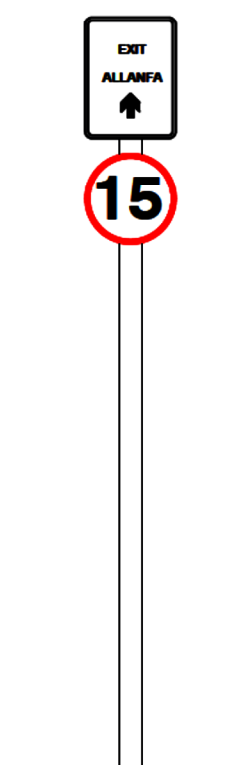

FRONT ELEVATION VIEW  
DOUBLE SIGN

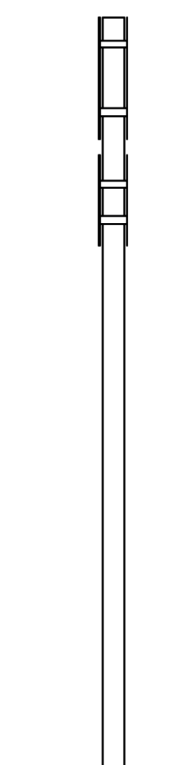

SIDE ELEVATION VIEW  
DOUBLE SIGN  
BOTH SIDE

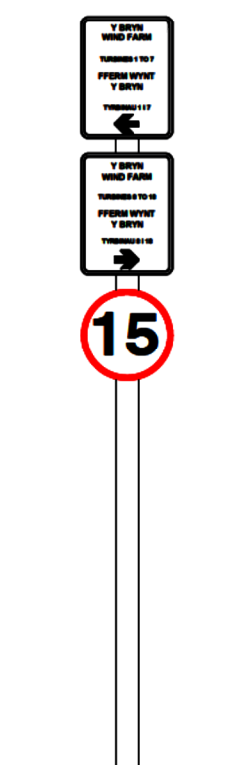

FRONT ELEVATION VIEW  
TRIPLE SIGN

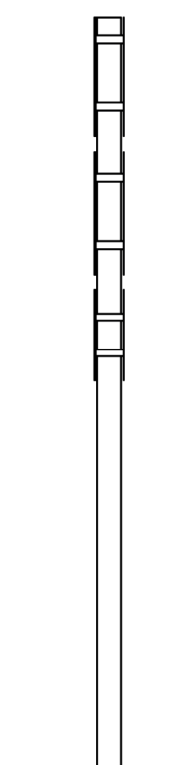

SIDE ELEVATION VIEW  
TRIPLE SIGN  
BOTH SIDE

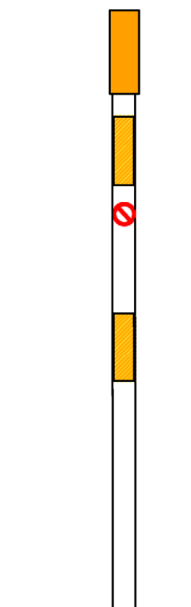

FRONT ELEVATION VIEW  
CABLE MARKER POST

PROPOSED DISPLAY VARIATIONS  
SCALE 1:25



NOTES:  
1. ALL DIMENSIONS ARE IN METRES UNLESS OTHERWISE STATED.  
2. THIS IS A TYPICAL ARRANGEMENT ONLY AND NOT FOR CONSTRUCTION.

Coordinate System: British National Grid  
Projection: Transverse Mercator  
Datum: OSGB 1936  
Units: Meter  
Client: ESB/Coriolis Energy

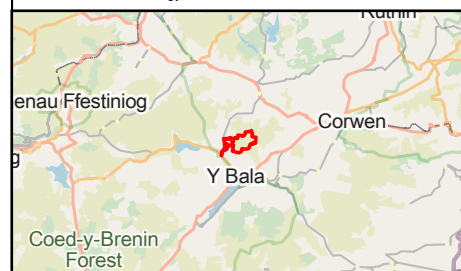

Rev	Date	Description	Drm	Chk	App
00	05/11/2025	First Draft	AW	KS	KS

Foel Fach Wind Farm



TITLE: Figure 2.18 Indicative Directional Signage

ID: P664094\_Figure 2-19\_IndicativeDirectionalSignage

Scale: 1:25 @ A3

REV 00



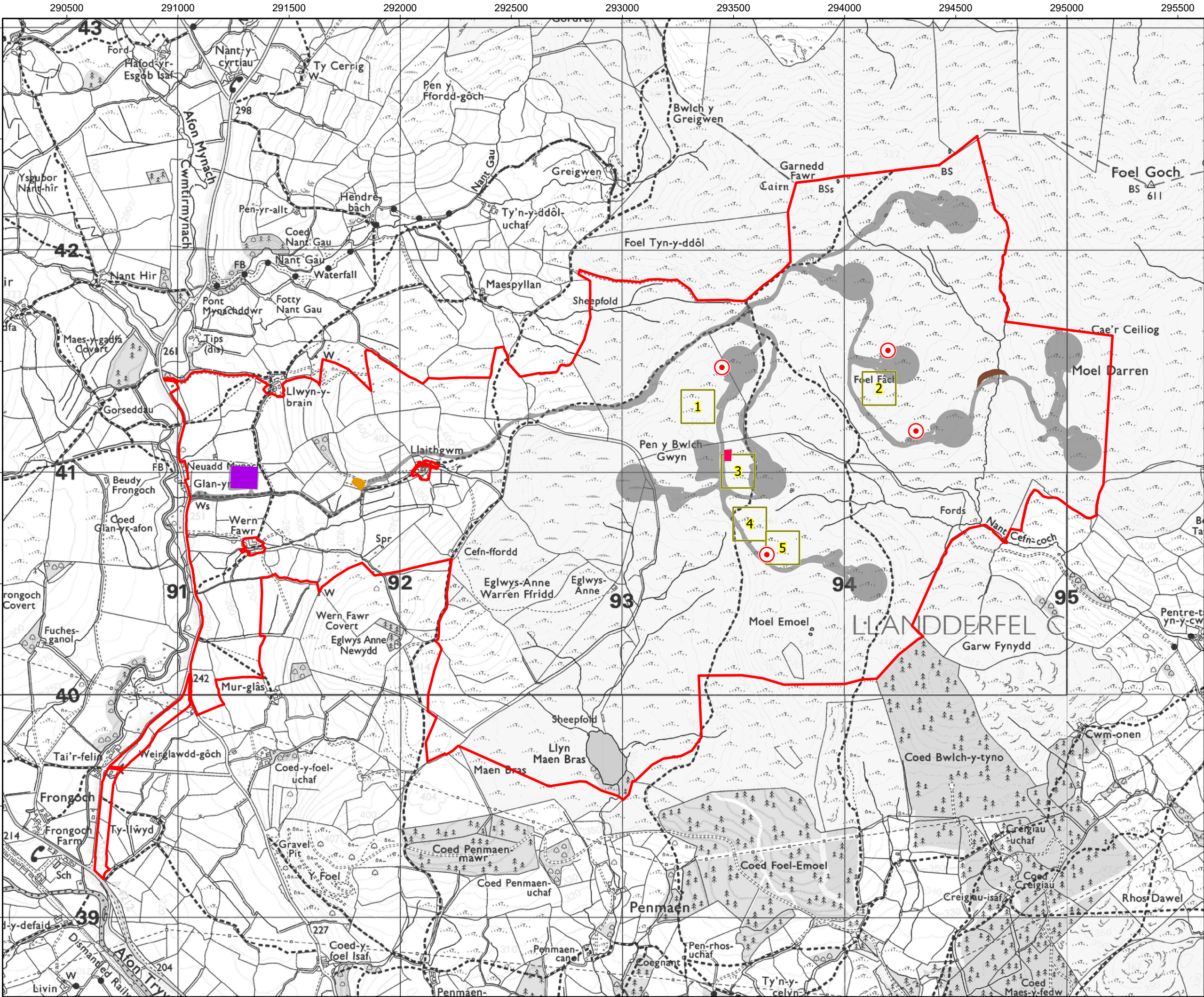

- Legend:
- Site Boundary
  - Potential Peat Stockpile Area
  - Borrow Pit
  - Concrete Batching Compound
  - Bridge Temporary Working Area
  - Construction Compound
  - Temporary Storage Area (if required)
  - Turbine and Infrastructure Footprint

Coordinate System: British National Grid  
Projection: Transverse Mercator  
Datum: OSGB 1936  
Units: Meter  
Client: ESB/Coriolis Energy



02	05/11/2025	Removed Storage Area	AW	KS	KS
01	30/10/2025	Updated Site Boundary	AW	KS	KS
00	27/10/2025	First Draft	FA	KS	MC
Rev	Date	Description	Drn	Chk	App

Foel Fach Wind Farm



TITLE: Figure 2.19  
Construction Layout

ID: P664094\_Figure2-18\_ConstructionLayoutPlan



Scale: 1:16,000 @ A3

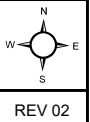

REV 02